



**X
A
M
I
G**

MACHINERY LIGHTING



Our story

GIMAX started in Italy in August 1990 in a small laboratory where electronic ballasts for fluorescent lamps at very low voltage were produced. The company developed design and production of electronic circuits with very high quality standards lodged into small enclosures. In 1991, the first range of portable and fix lamps was launched on the market. Beside production of electronics, the company started to produce power distribution assemblies made in butyl rubber, a highly dielectric material, with great technical features as resistance against shocks, acids and oils. The butyl rubber was combined with un-

breakable polycarbonate tubes, in order to give the product a robustness and compactness unknown in this sector up until then, becoming the quality trademark of the GIMAX production.

The power electronic circuit of this range of products completely designed and realised by the Company, covers the entire range of fluorescent tubes with significant small sizes compared with most of the items offered on the existent market. Next step became the production of a wide range of lighting products where electronic circuits as active components were a fundamental element. The development of these



CERTIFICATE No. 50 100 9199



CERTIFICATE No. 50 100 14389



products and the subsequent targeted commercial actions gave GIMAX the possibility to access many sectors such as shipyards, building companies as well as industrial maintenance. In these typical harsh environments, the GIMAX products are highly appreciated because of their reliability, safety, robustness and great performances. The achieved success is the consequence of the high level of customer satisfaction, in particular of the final consumer, by using GIMAX products. This allowed the company to expand its product range to enter new market segments. In 1993, GIMAX intro-

duced the production of power distribution assemblies in hard butyl rubber. The new developments of lighting solutions on the market have taken Gimax to design a brand new product range of lamps in LED technology to satisfy safety and environmental needs at best. The recent decision to achieve the ISO 14001 Certification makes a company "green" oriented. Furthermore, the company has also turned its interest to the market of lighting for wide areas, a sector that Gimax has not explored yet.

Our way of operating on the market and our values

From a commercial point of view, the contact with the Customer is carried out through the technical department of the Company, capable to guarantee an elevated level of competence in this field aside from a daily presence on the territory. The visit to the Customers is very important to understand how the end users work, their most frequent problems and needs.

The first step is always represented by the customer through a "consultative" approach.

The best possible solution is studied with our Technical Department composed by qualified experts in the sector. This ends up in the realisation of the final product, in most cases a product made as bespoke.

Strengths at Gimax: ability to combine high quality standards with competitive costs; modern industrial processes through new technologies; attention to

detail and special needs, always trying to grant the best service. The Company is located in Pietrasanta and is dedicated to the production and assembly of electrical switchboards, lighting products and electronic circuits. The gained experience in direct contact with the end user has allowed a constant improvement in quality standards and number of produced items. Today we can grant our customers a wide offer to satisfy their needs.

The variety of the acquired experiences and a particular attention to the aftersales phase allowed GIMAX to develop new product types in line with the most recent trends. Since always, Gimax has invested great part of its resources in Research and Development activities being proud to be a leader on the market in terms of innovation capabilities. The Company has consolidated its own experience in some specific sectors:

- BUILDING SITES
- SHIPYARDS
- INDUSTRY
- REFINERIES
- PUBLIC AND PRIVATE BODIES
- MILITARY
- FILM PRODUCTION
- MACHINE TOOLS

In these sectors, GIMAX has always been a point of reference for many leading companies for several years.



Certification and Compliance



Commitment, perseverance and dedication are the guidelines of the company to offer new solutions always respecting the most restricted Standards on domestic and foreign market.

The company management has been certified by TUV as in compliance with the following standards:

UNI EN ISO 9001:2015 (quality) and UNI EN ISO 14001:2015 (environment).

Our starting point will always be the same: the Client, his needs and the best possible answer to the specific problems.

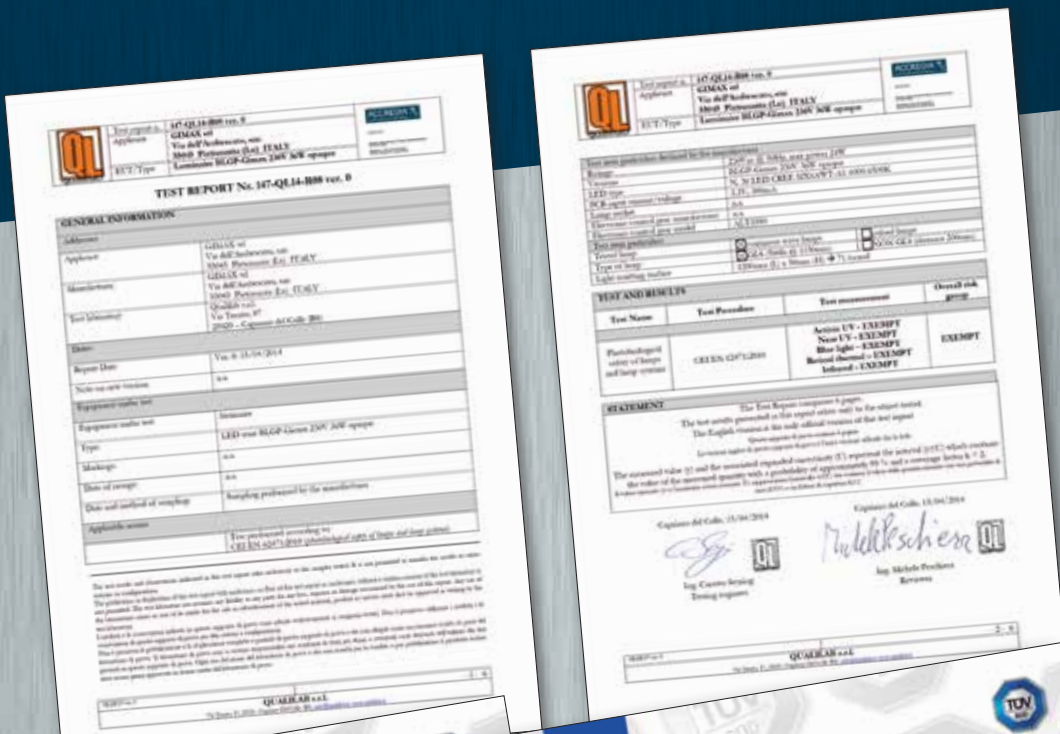

Index and Product Range

SIRIO LED Series | COMPACT LED



SIRIO BLM SERIES Ø 70 - Tube in **METHACRYLATE** page 08
- Tube in **BOROSILICATE GLASS** page 08



SIRIO BLS SERIES Ø 60 - Tube in **METHACRYLATE** page 10
- Tube in **BOROSILICATE GLASS** page 10



SIRIO BLG SERIES Ø 50 - Tube in **POLYCARBONATE** page 12



SIRIO BLR SERIES - Tube in **POLYCARBONATE** pag. 16



SIRIO CPLL SERIES Ø 50 - **PORTABLE** version page 18



SIRIO CPLL SERIES Ø 50 - **BATTERY** version page 20

SIRIO FLUORESCENT Series | COMPACT FLUORESCENT LAMPS



SIRIO BDM SERIES Ø 70 - Tube in **METHACRYLATE** page 24
- Tube in **BOROSILICATE GLASS** page 24



SIRIO BDS SERIES Ø 60 - Tube in **METHACRYLATE** page 26
- Tube in **BOROSILICATE GLASS** page 26



SIRIO BDG SERIES Ø 50 - Tube in **POLYCARBONATE** page 28



SIRIO CPF SERIES Ø 43-50 - **PORTABLE** version page 30

ORIENTAL Series



ORL-LED SERIES page 34

TRH-HALOGEN SERIES page 34



TRLH-LED SERIES page 34

TRH-HALOGEN SERIES page 34



TRLB-LED SERIES page 34

TRHB-HALOGEN SERIES page 34

LED SLIM Series | LINEAR LED



FLL-UF SERIES page 38



FLLP-ML SERIES page 39



FLL-US SERIES page 40

FLL-AS SERIES page 41

ACCESSORIES and SPARE PARTS



SIRIO SERIES - METAL BRACKETS page 44

- POLYPROPYLENE BRACKETS page 45

- ELECTRONIC BALLASTS page 46

ORIENTAL SERIES - ACCESSORIES AND SPARE PARTS page 47

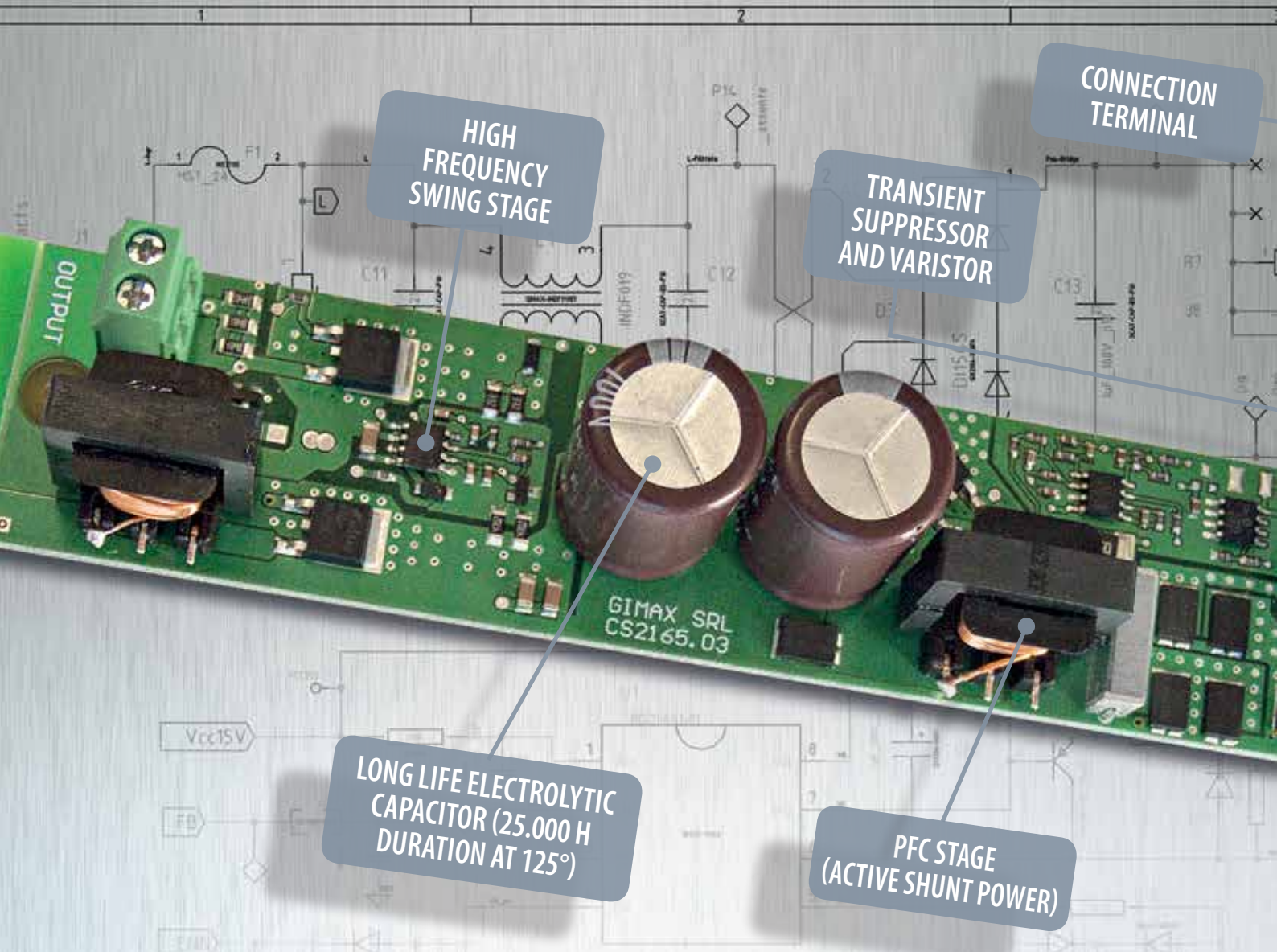

APPLICATIONS

Machine tools • CNC • Automation • Electrical switchboards • Lifting platforms
Cranes and containers • Paper mills • Work benches • Suction hoods • Tunnels • Subways

LED LIGHTING MODULES

Gimax LED lamps are built using LEDs with shape, dimensions and placement designed to optimize light emission. The colour temperature in use is 6500°K (cool white).

These products have been developed in compliance with the most restricted safety rules with regard to biocompatibility and to avoid the risk of eye damages.

Comparison of duration among the various light sources

Incandescent lamps500÷2.000 hours
Fluorescent lamps8.000÷20.000 hours
LED lamps.....50.000÷100.000 hours

Advantages of LED lighting

- LED diodes, high efficiency Lumileds (170 Lm/W)
- Average duration >50.000 hours
- Very low sensitivity to the repetitive switching-on
- No absorption peaks at switching-on
- Instantaneous light emission at switching-on
- Total exploitation of light emission at 180° with opal diffusers
- Colour rendering index CRI 80

- Energy efficiency class A+++
- Working temperature -20°C ÷ +50° C

ELECTRONIC BALLASTS (DRIVERS) WITH POWER FACTOR CORRECTION

- Made of high quality selected components and designed by the GIMAX R&D department.
- Electronic switching stage through PWM to keep the supplied current to the lamp as constant according to the voltage range shown from label data.
- The operating frequency is well above the threshold of human perception allowing to minimize the stroboscopic effect providing a pleasant visual well-being.
- Active PFC stage (Power Factor Corrector) to reduce apparent power absorption. The active stage C.C.M. (Continuous Conduction Mode) minimizes the peaks of current at switching-on and current waves of the EMC, input and output. Such features are very important in automation industry.

The system is protected against ESD (Electrostatic Discharge) and temporary extra-voltage.

Components guarantee a long lifespan and working temperature of the item.

- Voltage supply: 24V ac-dc, 48V ac-dc, 230V ac-dc. Other voltages on demand.
- In compliance with Standards EN60928 (Safety), EN 61547 (Immunity EMC), EN61000-3-2 (Wave suppression), EN61000-3-3 (Flickering), 61000-4-2 (electrostatic discharges), 61000-4-3 (electromagnetic fields), 61000-4-4 (fast transients), 61000-4-5 (over-voltages), 61000-4-6 (conducted disturbances), 61000-4-11 (changes in voltage), EN55015 (Radio disturbances), EN60598-1, EN 60598-2-1 (electrical equipment), EN61347-1 (general rules), EN61347-2-3 (Safety of electronic ballasts), EN60249-1 (components of electronic ballasts).

LAMP WITH METHACRYLATE TUBE (PPMA) TO BE USED IN LOW PRESENCE OF AGGRESSIVE CHEMICALS

- High transparency and brightness.
- Excellent resistance to wide temperature ranges as well as atmospheric and ageing agents.
- Good resistance to chemicals such as alkalis, weak

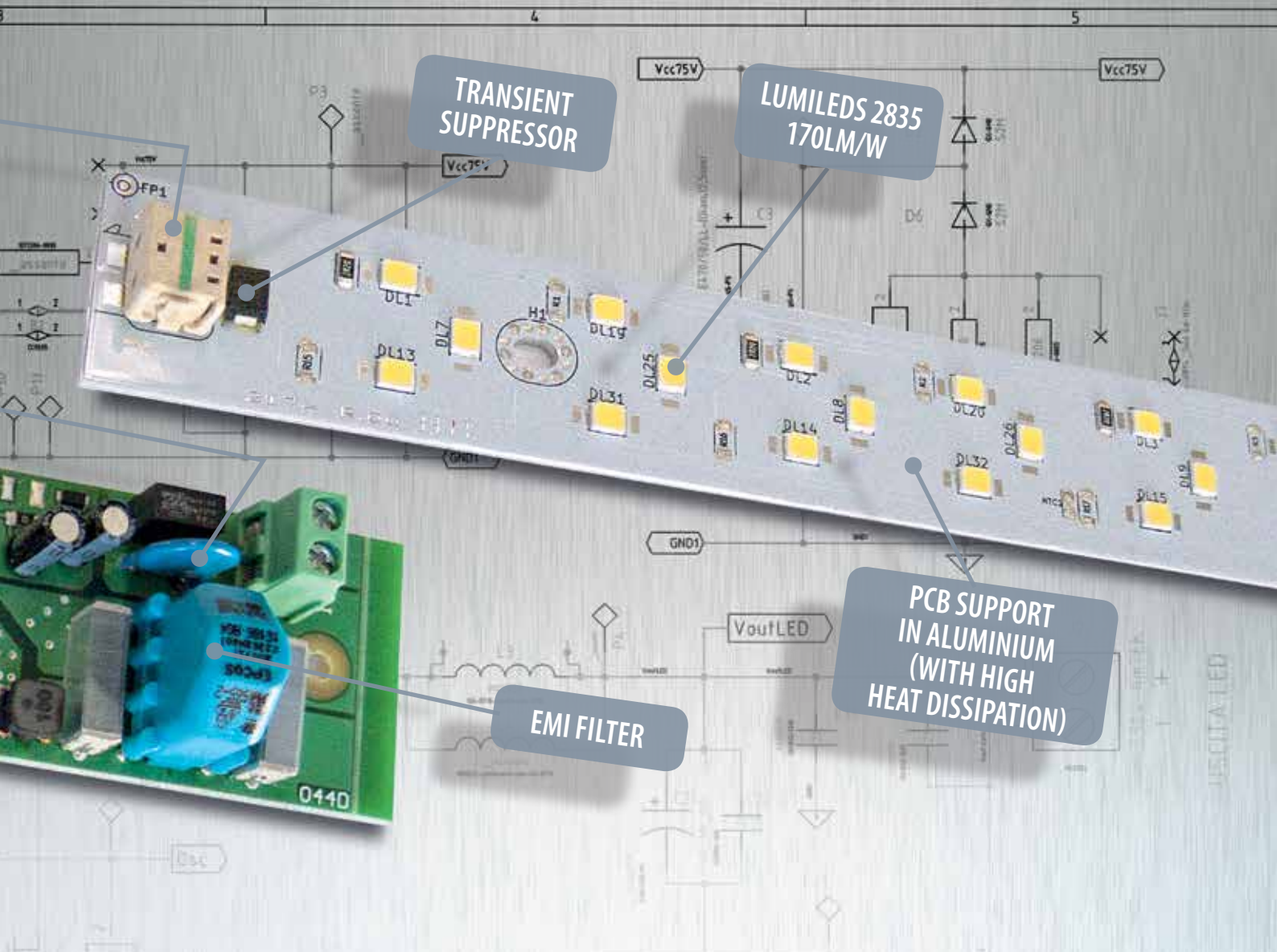

SIRIO LED Series | COMPACT LED

Lamps with tube in METHACRYLATE | BOROSILICATE GLASS | POLYCARBONATE

acids, inks, cosmetics and aliphatic hydrocarbons (oils and greases).

- Maximum working temperature 85-90°C.
- Tube thickness 5 mm, external diameter 60 or 70 mm

LAMP WITH TUBE IN BOROSILICATE GLASS TO BE USED IN HIGH PRESENCE OF AGGRESSIVE CHEMICALS

- Tube in PY borosilicate glass, high resistance to chemicals.
- Thermal shock DIN 52323 at 250°C.
- Thermal expansion (at 20÷300°C) 3,25 x 10 x K according to DIN 52328.
- High resistance to the most common chemicals such as alkalis, weak acids, inks, cosmetics and aliphatic hydrocarbons (oils and greases).
- Ovalization according to DIN 7184.
- Tube thickness 5 mm, external diameter 60 or 70 mm (+/- 1,5 mm).

LAMP WITH TUBE IN POLYCARBONATE (PC) TO BE USED IN PRESENCE OF NO AGGRESSIVE CHEMICALS

- High transparency and brightness.

- Very good resistance to shocks (virtually unbreakable).
- Low resistance to chemicals such as mineral acids of medium concentration, alcohols with the exception of methyl alcohol, aliphatic hydrocarbons (oils and greases).
- Maximum working temperature up to 100°C.
- Tube thickness 1,5 mm and external diameter 50mm

SIDE SEAL CAPS

- Side seal caps made of TAROPLAST (Taromid A 280 MT6) 6,6 loaded with 50% glass fiber (PA6,6+50%G.F.) to guarantee a good mechanical resistance against solicitations like traction, compression and flexion.
- Every cap is made of two distinct parts that, during the tightening of the three screws, push the silicone O-ring against the tube assuring the perfect seal against infiltrations (IP67 according the Regulations IEC529 and CEI 70-1).
- Cable gland IP68 PM20 made in Polyamide PA6.6 (cables Ø 7÷13mm) or PM16 (cables Ø 5÷10mm).
- Side seal caps are available with or without fixing feet

(Lamps Ø 50 and 60 mm).

INNER SUPPORT IN ALUMINIUM WITH OPAL DIFFUSOR

- Inner profile in extruded aluminium to support electrical components and to allow heat dissipation.
- Opal profile in polycarbonate, removable, to optimize light diffusion (180°) and to completely avoid the operator gets dazzled by light (no photobiological risk).
- Easily removable to obtain a narrow beam illumination (120°).

MOUNTING BRACKETS

- Mounting brackets made in electro-galvanised or stainless steel AISI 304 tightened by screws (Ø 60 and 70mm) equipped with soft rubber anti-vibration rings.
- Mounting brackets made in thermoplastic material with an excellent chemical resistance to inorganic acids and alkaline solutions. Limited resistance to acetone, organic acids, gasoline, benzol, diesel and oils. Working temperatures -20°C +70°C.

SIRIO BLM Series

LED lamps with tube \varnothing 70 mm



Features

- Protective outer tube in Methacrylate (PPMA) or Borosilicate Glass (PY), thickness 5mm
- Side seal caps with protection degree IP67 (IEC 529, IEC 144, CEI 70-1)
- Waterproof cable gland (IP68) PM20
- Inner slide in extruded aluminium
- Removable opal diffusor
- Various models of mounting brackets on demand
- Drivers with power factor correction ($>0,95$) designed and realised by GIMAX R&D department
- Construction in compliance with the current rules for the CE marking
- Very high efficiency LED modules (Lumileds) with colour temperature 6500°K, average lifetime >50.000 hours
- No photobiological risk
- Colour rendering index CRI 80
- Working temperature $-20^{\circ}\text{C} \div +50^{\circ}\text{C}$
- Energy efficiency class A+++
- Class of insulation: II / III
- Light beam angle: 180° with opal diffusor

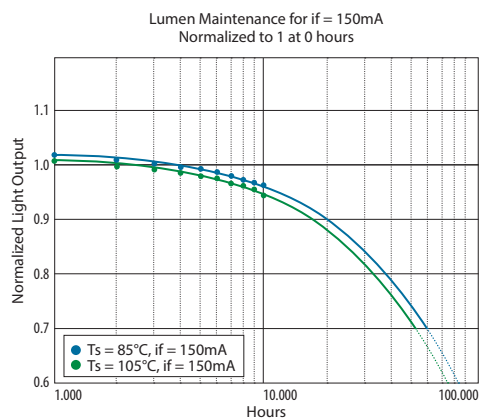

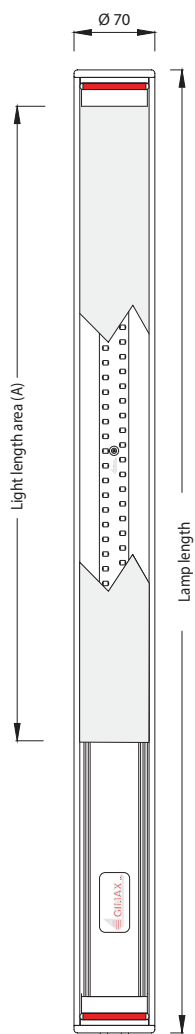

Standard version

Outer tube in METHACRYLATE

Item	Power W	Volt. V	Power factor	Luminous flux Lm (25°C)	Lamp length mm	Light length area (A) mm
BLMMN1212400	12	24V AC-DC	> 0,95	2100	505	290
BLMMN1812400	18			3060	660	425
BLMMN2622400	26			4460	1060	780
BLMMN4032400	40			6690	1465	1185
BLMMN1214800	12	48V AC-DC	> 0,95	2100	505	290
BLMMN1814800	18			3060	660	425
BLMMN2624800	26			4460	1060	780
BLMMN4034800	40			6690	1465	1185
BLMMN1212200	12	230V AC-DC	> 0,95	2100	505	290
BLMMN1812200	18			3060	660	425
BLMMN2622200	26			4460	1180	820
BLMMN4032200	40			6690	1565	1215

Outer tube in BOROSILICATE GLASS

Item	Power W	Volt. V	Power factor	Luminous flux Lm (25°C)	Lamp length mm	Light length area (A) mm
BLMBN1212400	12	24V AC-DC	> 0,95	2100	505	290
BLMBN1812400	18			3060	660	425
BLMBN2622400	26			4460	1060	780
BLMBN4032400	40			6690	1465	1185
BLMBN1214800	12	48V AC-DC	> 0,95	2100	505	290
BLMBN1814800	18			3060	660	425
BLMBN2624800	26			4460	1060	780
BLMBN4034800	40			6690	1465	1185
BLMBN1212200	12	230V AC-DC	> 0,95	2100	505	290
BLMBN1812200	18			3060	660	425
BLMBN2622200	26			4460	1180	820
BLMBN4032200	40			6690	1565	1215

NOTE: Custom solutions available on demand (Voltages, Power, etc.)

Mounting brackets | Dimensions and features on page 40/41



Item **STD1**
Item **STD1/INOX**



Item **STD2**
Item **STD2/INOX**



Item **STD3**



Item **CLC70**

SIRIO BLS Series

LED lamps with tube \varnothing 60 mm



Features

- Protective outer tube in Methacrylate (PPMA) or Borosilicate Glass (PY), thickness 5mm
- Side seal caps with protection degree IP67 (IEC 529, IEC 144, CEI 70-1) with or without fixing feet
- Waterproof cable gland (IP68) PM16
- Inner slide in extruded aluminium
- Removable opal diffusor
- Various models of mounting brackets on demand
- Drivers with power factor correction (>0.95) designed and realised by GIMAX R&D department
- Construction in compliance with the current rules for the CE marking
- Very high efficiency LED modules (Lumileds) with colour temperature 6500°K, average lifetime >50.000 hours
- No photobiological risk
- Colour rendering index CRI 80
- Working temperature $-20^{\circ}\text{C} \div +50^{\circ}\text{C}$
- Energy efficiency class A+++
- Class of insulation: II / III
- Light beam angle: 180° with opal diffusor

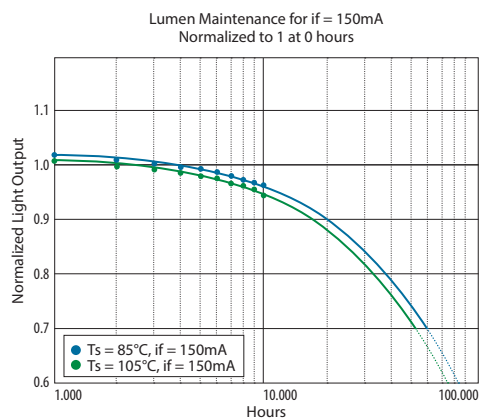

IP67



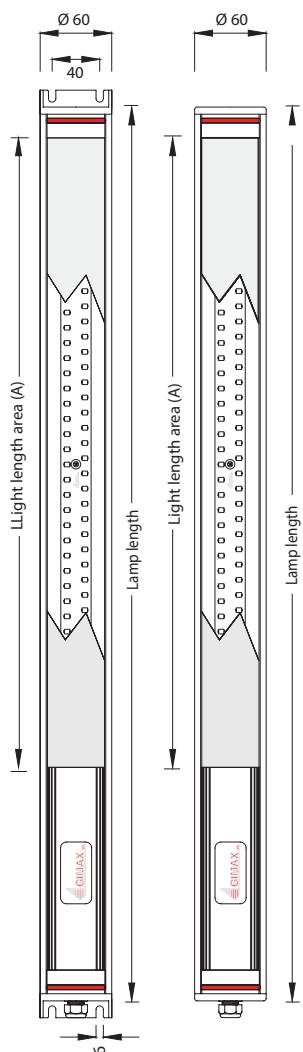

Version with fixing feet, add "S" to the item



Standard version

Outer tube METHACRYLATE

Item	Power W	Volt. V	Power factor	Luminous flux Lm (25°C)	Lamp length mm	Light length area (A) mm
BLSMN1212400	12	24V AC-DC	> 0,95	2100	495	290
BLSMN1812400	18			3060	650	425
BLSMN2622400	26			4460	1050	780
BLSMN4032400	40			6690	1455	1185
BLSMN1214800	12	48V AC-DC	> 0,95	2100	495	290
BLSMN1814800	18			3060	650	425
BLSMN2624800	26			4460	1050	780
BLSMN4034800	40			6690	1455	1185
BLSMN1212200	12	230V AC-DC	> 0,95	2100	495	290
BLSMN1812200	18			3060	650	425
BLSMN2622200	26			4460	1170	830
BLSMN4032200	40			6690	1555	1215

Outer tube in BOROSILICATE GLASS

Item	Power W	Volt. V	Power factor	Luminous flux Lm (25°C)	Lamp length mm	Light length area (A) mm
BLSBN1212400	12	24V AC-DC	> 0,95	2100	495	290
BLSBN1812400	18			3060	650	425
BLSBN2622400	26			4460	1050	780
BLSBN4032400	40			6690	1455	1185
BLSBN1214800	12	48V AC-DC	> 0,95	2100	495	290
BLSBN1814800	18			3060	650	425
BLSBN2624800	26			4460	1050	780
BLSBN4034800	40			6690	1455	1185
BLSBN1212200	12	230V AC-DC	> 0,95	2100	495	290
BLSBN1812200	18			3060	650	425
BLSBN2622200	26			4460	1170	830
BLSBN4032200	40			6690	1555	1215

NOTE: Custom solutions available on demand (Voltages, Power, etc.)

Mounting brackets | Dimensions and features at page 40/41



Item **STD1/60**
Item **STD1/60/INOX**



Item **STD2/60**



Item **CLC60**



Version with fixing feet, add "S" to the item

SIRIO BLG Series

LED lamps with tube \varnothing 50 mm



Features

- Protective outer tube in Polycarbonate (PC), thickness 1,5mm
- Side seal caps with protection degree IP67 (IEC 529, IEC 144, CEI 70-1)
- Waterproof cable gland (IP68) PM20
- Inner slide in extruded aluminium
- Removable opal diffuser
- Various models of mounting brackets on demand
- Drivers with power factor correction ($> 0,95$) designed and realised by GIMAX R&D department
- Construction in compliance with the current rules for the CE marking
- Very high efficiency LED modules (Lumileds) with colour temperature 6500°K, average lifetime >50.000 hours
- No photobiological risk
- Colour rendering index CRI 80
- Working temperature $-20^{\circ}\text{C} \div +50^{\circ}\text{C}$
- Energy efficiency class A+++
- Class of insulation: II / III
- Light beam angle: 180° with opal diffuser



Lumen Maintenance for $if = 150\text{mA}$
Normalized to 1 at 0 hours

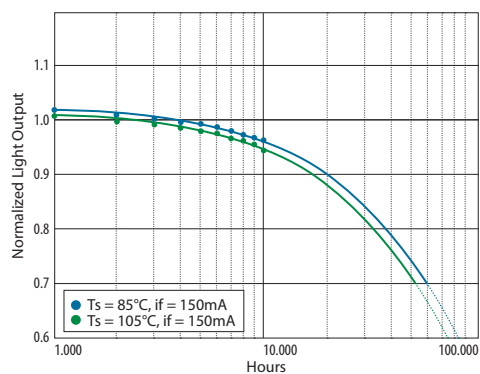

IP67



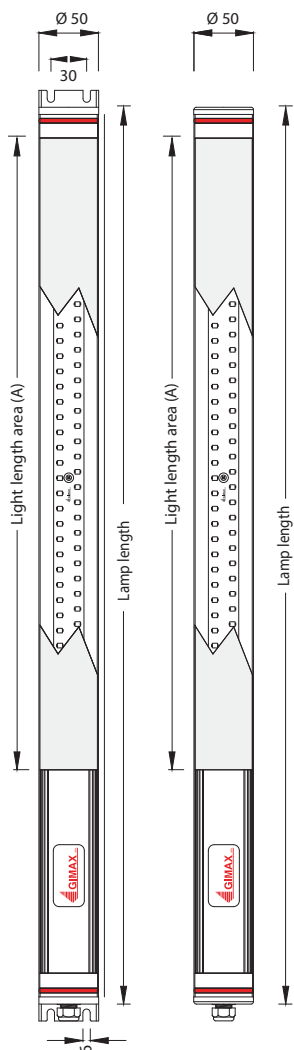

Tube in POLYCARBONATE

Item	Power W	Volt. V	Power factor	Luminous flux Lm (25°C)	Lamp length mm	Light length area (A) mm
BLGPN1212400	12	24V AC-DC	> 0,95	2100	475	275
BLGPN1812400	18			3060	640	425
BLGPN2622400	26			4460	1050	790
BLGPN4032400	40			6690	1445	1185
BLGPN1214800	12	48V AC-DC	> 0,95	2100	475	275
BLGPN1814800	18			3060	640	425
BLGPN2624800	26			4460	1050	790
BLGPN4034800	40			6690	1445	1185
BLGPN1212200	12	230V AC-DC	> 0,95	2100	475	275
BLGPN1812200	18			3060	640	425
BLGPN2622200	26			4460	1160	830
BLGPN4032200	40			6690	1545	1215

NOTE: Custom solutions available on demand (Voltages, Power, etc.)



Version with fixing feet, add "S" to the item



Standard version

Mounting brackets | Dimensions and features at page 41



Item **OBO/01**



Item **CLC50**



Version with fixing feet, add "S" to the item



APPLICATIONS

Machine tools • Machining centres • Automation
• Electrical panels for vehicle lifts • Work benches • Fume hoods

Technological development and new construction techniques have enabled energy and dimensional efficiency processes to be implemented in various fields, not just in the industrial ones. In fact, we are living in a historical moment where the search for sustainability has become the center of everyday life. Energy savings are coupled with the lower consumption of resources in terms of materials, so design and industry can also

not be exempted from the search for new industrial processes that are constantly being reviewed to optimize the finished product. In this regard, Gimax has been investing for years in both quality certifications such as the recent acquisition of the ISO 14001 and concreteness to the “green project” starting to revise the entire product range developing innovative solutions to meet new market requirements.

Today Gimax has started to manufacture, in addition to the historic models of tubular lamps, initially fluorescent tubes and later LED diodes, the series Sirio BLR, a new range of products characterized by innovative dimensional criteria. It is able to cover the most varied needs in terms of power, lamp length and brightness. Thanks to several developments on the electronic circuit, it is now possible to get a much



SIRIO BLR Series

more powerful light output than in the past at the same power combined with extremely lower energy consumptions.

The lamp is designed to be used in environments where an extremely small radial size is required along with an excellent light output such as inside transfer machines and metal frames of vehicle lifts. The product is extremely compact made in shock-proof

self-extinguishing polycarbonate V0. The aluminum extrusion, whose matrix is owned by Gimax, has been specially designed to get a better thermal exchange area through small ducts.

To ensure the maximum lifetime of the product in terms of working hours, LED modules are mounted on a metal sled connected to the outer extrusion.

This solution allows the energy generated by LEDs in

the form of heat to be optimally transferred outwards to get more than 50,000 hours operating (equivalent to almost 6 years of continuous use). The lamp is completely maintenance-free and connected to the 24Vdc power network by means of an M12 connector. The wall mounting of the product is done through fixing feet integrated into the structure of the sealing caps which perform a dual function.

SIRIO BLR Series

Polycarbonate LED lamps with reduced section



- Self-extinguishing opal polycarbonate outer tube V0 with thickness 1 ± 0.15 mm
- Sealing caps in PA6 30% loaded with glass spheres
- Integrated fasteners - Aluminium support sled with thermal dissipator function - Aluminum extrusion with a special matrix designed for maximum thermal dissipation of LED modules - CE marking
- Very high-efficiency LED modules (Lumileds) with color temperature 6500°K, average duration >50,000 hours
- Photobiological risk-free
- Color rendering CRI 80
- Working temperature $-20^{\circ}\text{C} \div +50^{\circ}\text{C}$
- Male connector M12 - A
- Maintenance-free
- Supply voltage 24Vdc
- Energy efficiency class A+++
- Isolation class: III
- Light beam angle: 120° with opal diffuser



tube in POLYCARBONATE

Item	Pow. W	Volt. V	Luminous flux Lm (25°C)	Lamp length mm	Total length (with brackets)	Drilling distance
BLR07240M12U	7	24V DC	1050	275	325	310 x 20 mm
BLR12240M12U	12		1750	430	485	467 x 20 mm
BLR24240M12U	24		3500	825	875	860 x 20 mm
BLR36240M12U	36		5250	1215	1265	1251 x 20 mm

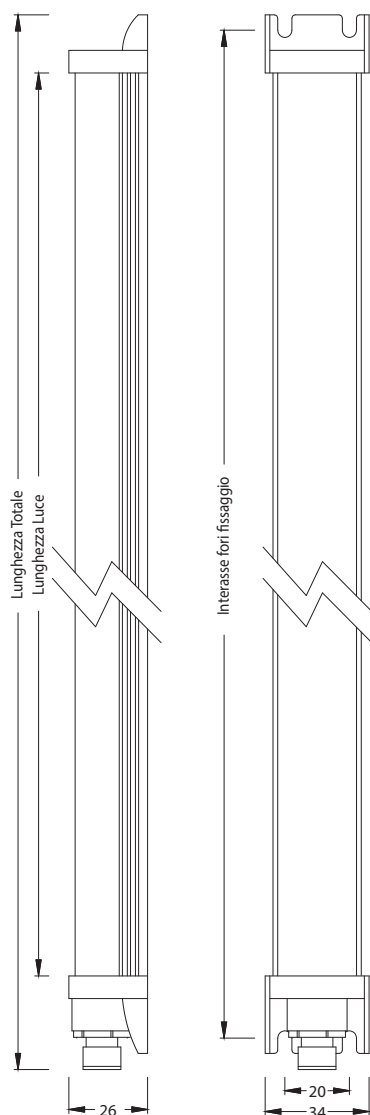

BLR external drivers

Power	Driver code	Max dimensions mm	M12 coupler code
7 - 12 - 24	LS.AL3024	125 x 38 x 23 (h)	PV6044TS/M12A
36	LS.ALT6024	230 x 32 x 22 (h)	

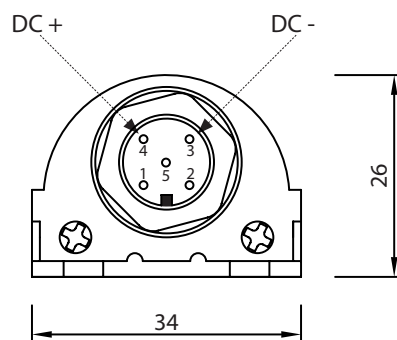

M12-A wiring diagram

Pin	Use
1	N.A.
2	N.A.
3	(-) Negative
4	(+) Positive
5	N.A.

SIRIO CPLL Series

LED lamps with tube \varnothing 50 mm



Features

- Protective outer tube in Polycarbonate (PC), thickness 1,5mm
- Handle and end cap in Butyl Rubber IP55 (IEC529, IEC144, CEI 70-1)
- Hook suitable for hanging
- Inner slide in extruded aluminium
- Removable opal diffuser
- Various models of mounting brackets upon separate request
- Drivers with power factor correction ($> 0,95$) designed by GIMAX R&D department
- Construction in compliance with CE marking rules
- Very high efficiency LED modules (Lumileds) with colour temperature 6500°K, lifetime > 50.000 hrs
- No photobiological risk
- Colour rendering CRI 80
- Working temperature $-20^{\circ}\text{C} \div +50^{\circ}\text{C}$
- Energy efficiency class A+++
- Class of insulation: II / III
- Light beam angle: 180° with opal diffuser
- Ideal for portable or fixed use



Lumen Maintenance for $if = 150\text{mA}$
Normalized to 1 at 0 hours

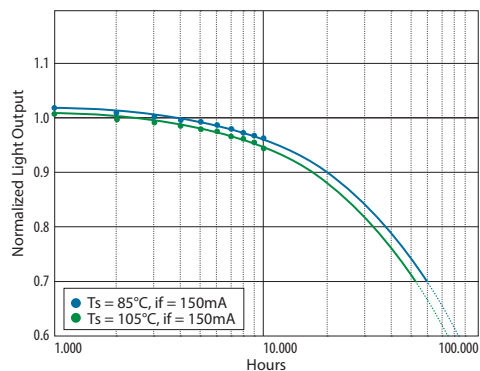

IP55



Lamps supplied with neoprene cable H07RN-F

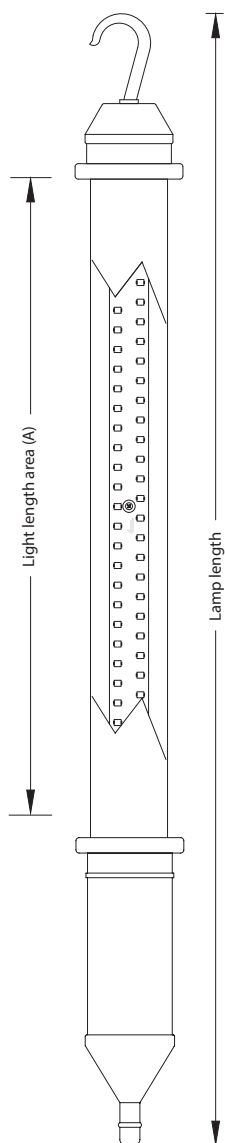

Item	Power W	Volt. V	Power factor	Luminous flux Lm	Lamp length mm	Light length area (A) mm	Cable length H07RN-F	Mobile plug CEE P17 IP67
CPLLN0912421S	9	24V AC-DC	> 0,95	1300	550	225	5 mt.	24V 16A 2P
CPLLN1212421S	12			2100	605	280		
CPLLN1812421S	18			3060	800	400		
CPLLN3622421S	36			6120	1220	800		
CPLLN0914823S	9	48V AC-DC	> 0,95	1300	550	225	5 mt.	48V 16A 2P
CPLLN1214823S	12			2100	605	280		
CPLLN1814823S	18			3060	800	400		
CPLLN3624823S	36			6120	1220	800		
CPLLN091222AS	9	230V AC-DC	> 0,95	1300	550	225	5 mt.	230V 16A 2P+T
CPLLN121222AS	12			2100	605	280		
CPLLN181222AS	18			3060	800	400		
CPLLN362222AS	36			6120	1275	800		

Lamps supplied with spiral cable PVC 03VV

Item	Power W	Volt. V	Power factor	Luminous flux Lm	Lamp length mm	Light length area (A) mm	Spiral cable length PVC	Mobile plug CEE P17 IP67
CPLLN0912451S	9	24V AC-DC	> 0,95	1300	550	225	0,7÷4,5 mt.	24V 16A 2P
CPLLN1212451S	12			2100	605	280		
CPLLN1812451S	18			3060	800	400		
CPLLN3622451S	36			6120	1220	800		
CPLLN0914853S	9	48V AC-DC	> 0,95	1300	550	225	0,7÷4,5 mt.	48V 16A 2P
CPLLN1214853S	12			2100	605	280		
CPLLN1814853S	18			3060	800	400		
CPLLN3624853S	36			6120	1220	800		
CPLLN09122SAS	9	230V AC-DC	> 0,95	1300	550	225	0,7÷4,5 mt.	230V 16A 2P+T
CPLLN12122SAS	12			2100	605	280		
CPLLN18122SAS	18			3060	800	400		
CPLLN36222SAS	36			6120	1275	800		

NOTE: Custom solutions available on demand (Voltages, Power, etc.)

Mounting brackets | Dimensions and features at page 41



Item **OBO/01**



Item **MGP01/0B001**
Magnet
with ring Ø 50



Item **CLC50**

SIRIO CPLL Series

LED lamps with rechargeable battery



Features

- Protective outer tube in Polycarbonate (PC) thickness 1,5mm
- Handle and end cap in watertight Butyl Rubber IP55 (IEC529, IEC144, CEI 70-1)
- Rear connector to the battery charger
- Front glass to protect the LED (spot light beam)
- Various models of mounting brackets upon separate request
- Drivers with power factor correction with emergency function
- Construction in compliance with CE marking rules
- Very high efficiency LED modules (Lumileds) with colour temperature 6500°K, lifetime >50.000 hrs
- No photobiological risk
- Colour rendering CRI 80
- Working temperature $-20^{\circ}\text{C} \div +50^{\circ}\text{C}$
- Energy efficiency class A+++
- Class of insulation: II / III
- Light beam angle: 180° with opal diffuser
- Ideal for portable, fixed and emergency use



Lumen Maintenance for $i_f = 150\text{mA}$
Normalized to 1 at 0 hours

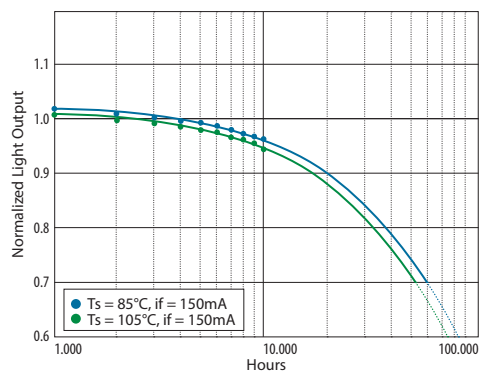

IP55





Portable lamp with battery, including a battery charger.
High efficiency LED light output through the following three different lighting groups:

Front lighting module

Placed on top of the lamp, composed by no. 1 LED with its own optical group, spot and directional. Usually used for inspection purposes.

Main lighting module

Placed along the axis of the main lamp body, composed by more LEDs. It has been designed for environmental lighting. Angle light beam 180°.

Signalling lighting module (optional)

Placed along the axis of the main lamp body, composed by red-coloured LEDs. Flood monochromatic light emission, angle light beam 120°. Usually used for signalling purposes in case of imminent danger or presence of obstacles.

Description and functionality

Two buttons on the lamp handle:

no.1 button "ON" to sequentially switch on the lighting module.
nr.1 button "OFF" to switch off the switched-on lighting module.

In case of presence of power, every lighting module is normally turned off and cannot be turned on by the operator. As self-diagnosis, there is a visible light (red LED) on the outside of lamp body that indicates the presence of power.

In case there is no power, the front lighting module is automatically turned on ("EMERGENCY" function) making the item compatible with a fixed installation as well. After 60 minutes, the lamp is disconnected as in compliance with the current rules for safety on workplace. The accumulators still have a stored energy reserve to allow a supplementary autonomy for portable use or in case of a new sudden state of emergency.

The state of emergency can be interrupted in any moment through the available commands. In case of portable use, a light signal is present on the control panel advising about a low battery level.

The lamp has a separate battery-charger to be connected to the electrical network at 230V and inner accumulators with Ni-MH technology to use outside the network.

The load and unload processes are controlled by a microcontroller to optimize the duration in time. The battery pack is interchangeable and can be ordered as spare part.

On the handle, there is a pull-out connector, placed on the end of the lamp central axis provided of a dust proof cap anchored by a small chain to allow the cable connection (cable included) and recharge of inner accumulators.

Item	Description	Front module	Length mm	Weight gr.	Includes
CPLLN251221AS/EM	Portable battery lamp with LED lighting modules including adaptor with plug CEE P17 230V 16A 2P+E	500 Lumen	550	700	1h + charge residue for a supplementary emergency cycle of min. 4 h. charge
CPLLN251222AS/EM/R	Portable battery lamp with LED lighting modules and rear LED strip in red colour for signalling. Adaptor with plug CEE P17 230V 16A 2P+E	500 Lumen	550	700	1h + charge residue for a supplementary emergency cycle of min. 4 h. charge

Mounting brackets | Dimensions at page 41



Item **OBO/01**



Item **MGP01/OB001**
Magnet
with ring Ø 50



Item **CLC50**



APPLICATIONS

Machine tools • CNC • Automation • Electrical switchboards • Lifting platforms
Cranes and containers • Paper mills • Work benches • Suction hoods • Tunnels • Subways

FLUORESCENT LAMPS

For fluorescent tubular lighting solutions, GIMAX uses lamps of the main brand names that guarantee a constant degree of lighting in time. The colour temperature in use is 4000°K (cool white) to avoid the monochromatic effect (colour flattening).

Technical data and duration

- Model DULUX® 2G11 or LINEAR G13
- Working temperature -10°C ÷ +50°C
- Duration 8000 hours

HIGH FREQUENCY ELECTRONIC BALLASTS

- Made with selected components of elevated quality standards completely designed by GIMAX R&D department.
- High frequency electronic circuit with digital control switching. The functioning in high frequency prevents the operator, in case of working on rotating machines, to be exposed to the dangerous strobo-

scopic effect (illusion of the retainer piece) and offers a pleasant visual effect as well.

- Power stage with Power Mosfet, protected against outgoing short-circuits and no-load operations. In particular, the circuit continuously controls the state of the fluorescent tube to protect the operator and the lamps from problems regarding the righting reflex that occurs when the gas is finished.
- BUILT-IN fuse for power line protection.
- Voltage supply, 24V ac-dc, 48V ac-dc, 230V ac.
- In compliance Standards EN60928 (Safety), EN 61547 (Immunity EMC), EN61000-3-2 (Wave Suppression), EN61000-3-3 (Flickering), 61000-4-2 (electrostatic discharges, 61000-4-3 (electromagnetic fields), 61000-4-4 (fast transients), 61000-4-5 (over-voltages), 61000-4-6 (conducted disturbances), 61000-4-11 (voltage changes), EN55015 (Radio disturbances), EN60598-1, EN 60598-2-1 (electrical equipment), EN61347-1 (general rules), EN61347-2-3 (Safety of

electronic ballasts), EN60249-1 (components of electronic ballasts).

LAMP WITH METHACRYLATE TUBE (PPMA) TO USE IN PLACES WITH LOW PRESENCE OF AGGRESSIVE CHEMICAL AGENTS

- Incomparable features of transparency and brightness.
- Excellent resistance against any type of temperature, atmospheric and ageing agents.
- Good chemical resistance against alkalis and weak acids, inks, cosmetics and aliphatic hydrocarbons (oils and greases).
- Maximum temperature during continuous use 85-90°C.
- Tube thickness 5 mm, external diameter 60 or 70 mm

LAMP WITH TUBE IN BOROSILICATE GLASS TO USE IN PLACES WITH HIGH PRESENCE OF AGGRESSIVE



SIRIO FLUORESCENT Series | COMPACT FLUORESCENT

Lamps with tube in METHACRYLATE | BOROSILICATE GLASS | POLYCARBONATE

CHEMICAL AGENTS

- Tube in PY borosilicate glass with an elevated chemical and mechanical resistance.
- Maximum working temperature for short time periods 500°C.
- Thermal shock DIN 52323 at 250°C.
- Chemical resistance against alkalis and weak acids, inks, cosmetics and aliphatic hydrocarbons (oils and greases).
- Ovalization according to DIN 7184.
- Tube thickness 5 mm, external diameter 60 or 70 mm (+/- 1,5 mm).

LAMP WITH TUBE IN POLYCARBONATE (PC) TO USE IN PLACES WITH NO PRESENCE OF AGGRESSIVE CHEMICAL AGENTS

- Excellent features of transparency and brightness.
- Extraordinary resistance against shocks (practically unbreakable).

- Low resistance to chemicals such as mineral acids of medium concentration, alcohols except for methyl alcohol, aliphatic hydrocarbons (oils and greases).
- Maximum working temperature up to 100°C.
- Tube thickness 1,5 mm and external diameter 43 or 50mm

SIDE CLOSURES

- Side closures made of TAROPLAST (Taromid A 280 MT6) 6,6 loaded with 50% glass fibre (PA6,6+50%F.V) to guarantee a good mechanical resistance against solicitations such as traction, compression and flexion.
- Every closure is made of two distinct parts that, during the tightening of the three screws, open up the silicone O-ring against the tube assuring the perfect fit against infiltrations (IP67 according to Standards IEC529 and CEI 70-1).
- Cable gland IP68 in Polyamide PA6.6 provided of skin-top strain relief PM20 (cables Ø 7÷13mm) or PM16

(cables Ø 5÷10mm).

- Side closures are available with or without fixing feet (Lamps Ø 50 and 60 mm).

INNER SUPPORT IN ALUMINIUM

- Inner profile in extruded aluminium, painted white to guarantee the best diffusion of luminous flux.

MOUNTING BRACKETS

- Mounting brackets ring shape made in electro-galvanised or stainless steel AISI 304 provided of screws for tightening (Ø 60 and 70mm) and anti-vibration rubber strips.
- Mounting brackets in thermoplastic with excellent chemical resistance against inorganic acids and alkaline solutions. Limited resistance against acetone, organic acids, gasoline, benzol, diesel and oil. Maximum working temperatures -20°C +70°C.

SIRIO BDM Series

FLUORESCENT lamps with tube \varnothing 70 mm

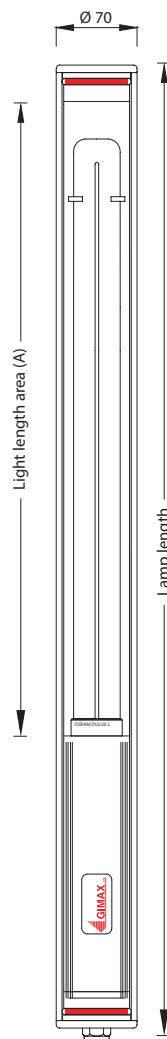

Features

- Protective outer tube in Methacrylate (PPMA) or in Borosilicate Glass (PY), thickness 5mm
- Side seal caps with protection degree IP67 (IEC529, IEC144, CEI 70-1)
- Waterproof cable gland (IP68) PM20
- Inner slide in extruded aluminium
- Various models of mounting brackets available on demand
- Electronic ballasts designed by GIMAX R&D
- Construction in compliance with current CE marking Standards
- Fluorescent tubes Dulux® or linear T8 with colour temperature 4000°K
- Working temperature $-10^{\circ}\text{C} \div +50^{\circ}\text{C}$
- Class of insulation: I
- Light beam angle: $120^{\circ}-180^{\circ}$



Standard version



FLUORESCENT LAMPS

Tube in METHACRYLATE

BUILT-IN electronic ballast

	Item	Power W	Volt. V	Luminous flux Lm (25°C)	Lamp length mm
Dulux®	BDMM18240	18	24V AC	1200	505
	BDMM24240	24		1800	605
	BDMM36240	36		2900	700
	BDMM55240	55		4800	825
	BDMM18220	18	230V AC	1200	505
	BDMM24220	24		1800	605
	BDMM36220	36		2900	700
	BDMM55220	55		4800	825
Linear	BDMM18240L	18	24V AC	1350	880
	BDMM36240L	36		3350	1490
	BDMM58240L	58		5200	1790
	BDMM18220L	18	230V AC	1350	880
	BDMM36220L	36		3350	1490
	BDMM58240L	58		5200	1790

Light length area (A) mm
240
340
435
560
240
340
435
560
620
1230
1530
620
1230
1530

SEPARATE electronic ballast

Item	Lamp length mm	Ballast in metal enclosure	Ballast in waterproof tube IP67
BDMM18000	365	E18D024S1	E18D024S3
BDMM24000	470	E24D024S1	E24D024S3
BDMM36000	560	E36D024S1	E36D024S3
BDMM55000	685	E55D024S1	E55D024S3
BDMM18000	365	E18D230S1	E18D230S3
BDMM24000	470	E24D230S1	E24D230S3
BDMM36000	560	E36D230S1	E36D230S3
BDMM55000	685	E55D230S1	E55D230S3
BDMM18000L	730	E18L024S1	E18L024S3
BDMM36000L	1365	E36L024S1	E36L024S3
BDMM58000L	1665	E58L024S1	E58L024S3
BDMM18000L	730	E18L230S1	E18L230S3
BDMM36000L	1365	E36L230S1	E36L230S3
BDMM58000L	1665	E58L230S1	E58L230S3

Tube in BOROSILICATE GLASS

BUILT-IN electronic ballast

	Item	Power W	Volt. V	Luminous flux Lm (25°C)	Lamp length mm
Dulux®	BDMB18240	18	24V AC	1200	505
	BDMB24240	24		1800	605
	BDMB36240	36		2900	700
	BDMB55240	55		4800	825
	BDMB18220	18	230V AC	1200	505
	BDMB24220	24		1800	605
	BDMB36220	36		2900	700
	BDMB55220	55		4800	825
Linear	BDMB18240L	18	24V AC	1350	880
	BDMB36240L	36		3350	1490
	BDMB58240L	58		5200	1790
	BDMB18220L	18	230V AC	1350	880
	BDMB36220L	36		3350	1490
	BDMB58220L	58		5200	1790

Light length area (A) mm
240
340
435
560
240
340
435
560
620
1230
1530
620
1230
1530

SEPARATE electronic ballast

Item	Lamp length mm	Ballast in metal enclosure	Ballast in waterproof tube IP67
BDMB18000	365	E18D024S1	E18D024S5
BDMB24000	470	E24D024S1	E24D024S5
BDMB36000	560	E36D024S1	E36D024S5
BDMB55000	685	E55D024S1	E55D024S5
BDMB18000	365	E18D230S1	E18D230S5
BDMB24000	470	E24D230S1	E24D230S5
BDMB36000	560	E36D230S1	E36D230S5
BDMB55000	685	E55D230S1	E55D230S5
BDMB18000L	730	E18L024S1	E18L024S5
BDMB36000L	1365	E36L024S1	E36L024S5
BDMB58000L	1665	E58L024S1	E58L024S5
BDMB18000L	730	E18L230S1	E18L230S5
BDMB36000L	1365	E36L230S1	E36L230S5
BDMB58000L	1665	E58L230S1	E58L230S5

NOTE: Custom solutions available on demand (Voltages, Power, etc.)

Mounting brackets | Dimensions and features at page 40/41



Item STD1
Item STD1/INOX



Item STD2
Item STD2/INOX



Item STD3



Item CLC70

SIRIO BDS Series

FLUORESCENT lamps with tube \varnothing 60 mm



Version
with fixing feet,
add "S"
to the item



Standard
version

Features

- Protective outer tube in Methacrylate (PPMA) or in Borosilicate Glass (PY), thickness 5mm
- Side seal caps with protection degree IP67 (IEC529, IEC144, CEI 70-1)
- Waterproof cable gland (IP68) PM16
- Inner slide in extruded aluminium
- Various models of mounting brackets available on demand
- Electronic ballasts designed by GIMAX R&D
- Construction in compliance with current CE marking Standards
- Fluorescent tubes Dulux® or linear T8 with colour temperature 4000°K
- Working temperature $-10^{\circ}\text{C} \div +50^{\circ}\text{C}$
- Class of insulation: I
- Light beam angle: 120° - 180°



FLUORESCENT LAMPS

Tube in METHACRYLATE

BUILT-IN electronic ballast

	Item	Power W	Volt. V	Luminous flux Lm (25°C)	Lamp length mm
Dulux®	BDSM18240	18	24V AC	1200	495
	BDSM24240	24		1800	595
	BDSM36240	36		2900	690
	BDSM55240	55		4800	815
	BDSM18220	18	230V AC	1200	495
	BDSM24220	24		1800	595
	BDSM36220	36		2900	690
	BDSM55220	55		4800	815
Linear	BDSM18240L	18	24V AC	1350	880
	BDSM36240L	36		3350	1490
	BDSM58240L	58		5200	1790
	BDSM18220L	18	230V AC	1350	880
	BDSM36220L	36		3350	1490
	BDSM58220L	58		5200	1790

Light length area (A) mm
240
340
435
560
240
340
435
560
630
1240
1540
630
1240
1540

SEPARATE electronic ballast

Item	Lamp length mm	Ballast in metal enclosure	Ballast in waterproof tube IP67
BDSM18000	370	E18D024S1	E18D024S4
BDSM24000	475	E24D024S1	E24D024S4
BDSM36000	565	E36D024S1	E36D024S4
BDSM55000	690	E55D024S1	E55D024S4
BDSM18000	370	E18D230S1	E18D230S4
BDSM24000	475	E24D230S1	E24D230S4
BDSM36000	565	E36D230S1	E36D230S4
BDSM55000	690	E55D230S1	E55D230S4
BDSM18000L	760	E18L024S1	E18L024S4
BDSM36000L	1360	E36L024S1	E36L024S4
BDSM58000L	1670	E58L024S1	E58L024S4
BDSM18000L	760	E18L230S1	E18L230S4
BDSM36000L	1360	E36L230S1	E36L230S4
BDSM58000L	1670	E58L230S1	E58L230S4

Tube in BOROSILICATE GLASS

BUILT-IN electronic ballast

	Item	Power W	Volt. V	Luminous flux Lm (25°C)	Lamp length mm
Dulux®	BDSB18240	18	24V AC	1200	495
	BDSB24240	24		1800	595
	BDSB36240	36		2900	690
	BDSB55240	55		4800	815
	BDSB18220	18	230V AC	1200	495
	BDSB24220	24		1800	595
	BDSB36220	36		2900	690
	BDSB55220	55		4800	815
Linear	BDSB18240L	18	24V AC	1350	880
	BDSB36240L	36		3350	1490
	BDSB58240L	58		5200	1790
	BDSB18220L	18	230V AC	1350	880
	BDSB36220L	36		3350	1490
	BDSB58220L	58		5200	1790

Light length area (A) mm
240
340
435
560
240
340
435
560
630
1240
1540
630
1240
1540

SEPARATE electronic ballast

Item	Lamp length mm	Ballast in metal enclosure	Ballast in waterproof tube IP67
BDSB18000	370	E18D024S1	E18D024S6
BDSB24000	475	E24D024S1	E24D024S6
BDSB36000	565	E36D024S1	E36D024S6
BDSB55000	690	E55D024S1	E55D024S6
BDSB18000	370	E18D230S1	E18D230S6
BDSB24000	475	E24D230S1	E24D230S6
BDSB36000	565	E36D230S1	E36D230S6
BDSB55000	690	E55D230S1	E55D230S6
BDSB18000L	760	E18L024S1	E18L024S6
BDSB36000L	1360	E36L024S1	E36L024S6
BDSB58000L	1670	E58L024S1	E58L024S6
BDSB18000L	760	E18L230S1	E18L230S6
BDSB36000L	1360	E36L230S1	E36L230S6
BDSB58000L	1670	E58L230S1	E58L230S6

NOTE: Custom solutions available on demand (Voltages, Power, etc.)

Mounting brackets | Dimensions and features at page 40/41



Item STD1/60
Item STD1/60/INOX



Item STD2/60



Item CLC60



Version with fixing feet, add "S" to the item

SIRIO BDG Series

FLUORESCENT lamps with tube \varnothing 50 mm

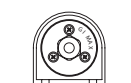

Version
with fixing feet,
add "S"
to the item



Standard
version

Features

- Protective outer tube in Polycarbonate (PC) thickness 1,5mm
- Side seal caps with protection degree IP67 (IEC529, IEC144, CEI 70-1)
- Waterproof cable gland (IP68) PM16
- Inner slide in extruded aluminium
- Various models of mounting brackets upon separate request
- Electronic ballasts designed by GIMAX R&D
- Construction in compliance with current CE marking Standards
- Fluorescent tubes Dulux® or linear T8 with colour temperature 4000°K
- Working temperature $-10^{\circ}\text{C} \div +50^{\circ}\text{C}$
- Class of insulation: I
- Light beam angle: $120^{\circ}-180^{\circ}$



FLUORESCENT LAMPS

Tube in POLYCARBONATE

BUILT-IN electronic ballast

	Item	Power W	Volt. V	Luminous flux Lm (25°C)	Lamp length mm	Light length area (A) mm
Dulux®	BDGP18240	18	24V AC	1200	455	220
	BDGP24240	24		1800	560	320
	BDGP36240	36		2900	650	415
	BDGP55240	55		4800	775	535
	BDGP18220	18	230V AC	1200	455	220
	BDGP24220	24		1800	560	320
	BDGP36220	36		2900	650	415
	BDGP55220	55		4800	775	535
Linear	BDGP18240L	18	24V AC	1350	865	620
	BDGP36240L	36		3350	1480	1230
	BDGP58240L	58		5200	1780	1535
	BDGP18220L	18	230V AC	1350	865	620
	BDGP36220L	36		3350	1480	1230
	BDGP58220L	58		5200	1780	1535

SEPARATE electronic ballast

Item	Lamp length mm	Ballast in metal enclosure	Ballast in waterproof tube IP67
BDGP18000	325	E18D024S1	E18D024S7
BDGP24000	425	E24D024S1	E24D024S7
BDGP36000	515	E36D024S1	E36D024S7
BDGP55000	640	E55D024S1	E55D024S7
BDGP18000	325	E18D230S1	E18D230S7
BDGP24000	425	E24D230S1	E24D230S7
BDGP36000	515	E36D230S1	E36D230S7
BDGP55000	640	E55D230S1	E55D230S7
BDGP18000L	740	E18L024S1	E18L024S7
BDGP36000L	1350	E36L024S1	E36L024S7
BDGP58000L	1650	E58L024S1	E58L024S7
BDGP18000L	740	E18L230S1	E18L230S7
BDGP36000L	1350	E36L230S1	E36L230S7
BDGP58000L	1650	E58L230S1	E58L230S7

NOTE: Custom solutions available on demand (Voltages, Power, etc.)

Mounting brackets | Dimensions and features at page 41



Item **OBO/01**



Item **CLC50**



Version with fixing feet, add "S" to the item

SIRIO CPF Series

FLUORESCENT lamps with tube \varnothing 43 mm and \varnothing 50 mm



Features

- Protective outer tube in Polycarbonate (PC), thickness 1,5mm
- External diameter 50mm or 43mm
- Handle and end cap in watertight Butyl Rubber IP55 (IEC529, IEC144, CEI 70-1)
- Cable gland in Butyl Rubber
- Hook for hanging
- Inner slide in extruded aluminium
- Various models of mounting brackets available on demand
- Electronic ballasts designed by GIMAX R&D
- Construction in compliance with current CE marking Standards
- Fluorescent tubes Dulux® 2G11 or Dulux® 2G7 with colour temperature 4000°K
- Working temperature -10°C ÷ +50°C
- Class of insulation: II
- Light beam angle: 180°
- Ideal for portable or fixed use



FLUORESCENT LAMPS

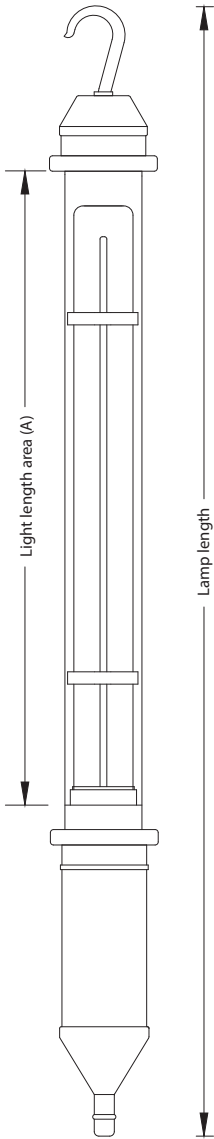

Lamps with cable H07RN-F (neoprene)

Item	Power W	Volt. V	Luminous flux Lm (25°C)	Lamp length mm	Light length area (A) mm	Polycarbonate tube diameter	Lamp type	Cable length H07RN-F	Mobile plug CEE P17 IP67
CPF112421S	11	24V AC	900	505	215	43	Dulux® SE	5 mt.	24V 16A 2P
CPF182421S	18		1200	630	220	50	Dulux® L		
CPF362421S	36		2900	830	420				
CPF552421S	55		4800	950	540				
CPF114823S	11	48V AC	900	505	215	43	Dulux® SE	5 mt.	48V 16A 2P
CPF184823S	18		1200	630	220	50	Dulux® L		
CPF364823S	36		2900	830	420				
CPF554823S	55		4800	950	540				
CPF11222AS	11	230V AC	900	505	215	43	Dulux® SE	5 mt.	230V 16A 2P+T
CPF18222AS	18		1200	630	220	50	Dulux® L		
CPF36222AS	36		2900	830	420				
CPF55222AS	55		4800	950	540				

Lamps with spiral PVC cable

Item	Power W	Volt. V	Luminous flux Lm (25°C)	Lamp length mm	Light length area (A) mm	Polycarbonate tube diameter	Lamp type	Length Spiral PVC cable	Mobile plug CEE P17 IP67
CPF1124S1S	11	24V AC	900	505	215	43	Dulux® SE	0,7÷4,5 mt.	24V 16A 2P
CPF1824S1S	18		1200	630	220	50	Dulux® L		
CPF3624S1S	36		2900	830	420				
CPF5524S1S	55		4800	950	540				
CPF1148S3S	11	48V AC	900	505	215	43	Dulux® SE	0,7÷4,5 mt.	48V 16A 2P
CPF1848S3S	18		1200	630	220	50	Dulux® L		
CPF3648S3S	36		2900	830	420				
CPF5548S3S	55		4800	950	540				
CPF1122SAS	11	230V AC	900	505	215	43	Dulux® SE	0,7÷4,5 mt.	230V 16A 2P+T
CPF1822SAS	18		1200	630	220	50	Dulux® L		
CPF3622SAS	36		2900	830	420				
CPF5522SAS	55		4800	950	540				

NOTE: Custom solutions available on demand (Voltages, Power, etc.)

Mounting brackets | Dimensions and features at page 41

Ø 43 mm		Ø 50 mm		
 Item OBO/02	 Item MGP01/OB002 Magnet with ring Ø 43	 Item OBO/01	 Item MGP01/OB001 Magnet with ring Ø 50	 Item CLC50



APPLICATIONS

Machine tools • Automation • Work benches • Looms

LED LIGHTING MODULES

LED lamps Series Gimax-ORIENTAL have a module composed by 6 LEDs with calibrated lenses to optimize the homogeneous distribution of the light. The colour temperature in use is 5000°K (cool white).

Comparison of duration between the various light sources

Incandescent lamps500÷2.000 hours

LED lamps.....25.000 hours

Advantages of LED lighting

- LED diodes high efficiency >100 Lm/W
- Average duration 25.000 hours
- Instantaneous light emission at the switching-on

- Total exploitation of the light emission
- Colour rendering index CRI 80
- Energy efficiency class A+++
- Working temperature -20°C ÷ +50° C

HALOGEN LIGHTING MODULES

Lamps Series Gimax-ORIENTAL use halogen lamps of last generation at an extra low safety voltage with glasses that filter the ultraviolet rays (UV-STOP). These lamps are insensitive to vibrations thanks to their very short and robust filaments. They have an anti-loosening connection (PK22-S) and the warm colour temperature typical for halogen lamps.

- Average duration 1000 hours
- Instantaneous light emission at the switching-on
- Working temperature -20°C ÷ +50° C

DRIVERS FOR THE LED VERSION

- Made with selected components of high quality.
- The operating frequency is well above the threshold of human perception and allows therefore to minimize the stroboscopic effect on the light emission providing a pleasant visual well-being.
- To guarantee such a duration, components in use completely correspond to the features that usage requires in terms of duration and working temperature.



ORIENTAL Series

- Voltage supply 12Vac-dc, 24V ac-dc.

LAMP TUBE

- The head of the lamp is completely made of extruded or die-cast aluminium with antioxidant treatment resistant against oils and various industrial aggressive substances.
- Tempered protective glass with perimetric oil proof O-ring.
- Closure through a flange with metric screws or threaded ring.
- Good chemical resistance against chemicals such as alkalis and weak acids, inks, cosmetics and aliphatic

hydrocarbons (oils and greases).

- Protection degree IP65.
- Thermoplastic handle resistant to oils suitable for light beam orientation.
- ON-OFF switch mounted on the back of the top of the head or on the handle.

MOVABLE ARMS AND FIXING BASE

- Arms entirely made of aluminium through anti-oxidant treatment, available in various lengths to satisfy different types of applications.
- Oil proof semi-spherical joints made in die-cast aluminium or thermoplastic. Screws with tightening

nuts to regulate rotation and O-rings in Teflon (aluminium models) to facilitate movements.

- Oil proof fixing base made in thermoplastic or steel with anti-rust treatment. Terminal blocks for connection to power supply provided of four fixing holes.

ACCESSORIES

- Various accessories available: angled brackets for wall-mounting, screw clamps for temporary fixation to tables and anti-glare grids for halogen lamps.

Oriental Series

LED and HALOGEN lamps



Features

- LED modules 6x2W or 5W with high luminous efficiency and long lifetime (25000 hrs) with optical diffusor, colour temperature >5000°K or halogen lamp with high luminous efficiency and long lifetime (1000 hrs) connection PK22s maximum power 70W
- Electronic ballast (LED version) 12-24Vac-dc to guarantee a long lifetime to Leds
- Lamp Tube in extruded or die-cast aluminium with anti-oxidant treatment, orientation by means of top handle
- Waterproof rear closure IP65
- Shockproof tempered glass with oil proof perimetric O-ring
- Flood light beam reflector in polished aluminium (halogen version) connection PK22s
- ON-OFF switch mounted on the handle or on the back of the lamp
- Waterproof movable arms in extruded aluminium with anti-oxidant treatment
- Semi-spherical joints in insulated material or die-cast aluminium
- Base provided of four holes suitable for fixing
- Standard versions 12-24Vac-dc, 230V
- Various accessories for fixation



IP65 

LED AND HALOGEN

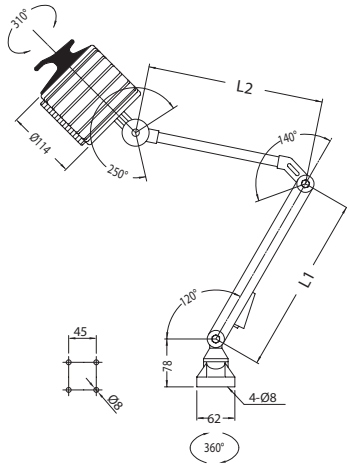

Series ORL-LED

Item	Power W	Volt. V	Lumen	Length L1 mm	Length L2 mm
ORLH122428	12	24 ac-dc	1290	420	490
ORLH122427	12	24 ac-dc	1290		
ORLH122426	12	24 ac-dc	1290	320	490
ORLH122425	12	24 ac-dc	1290	260	380
				220	280

Series TRH-HALOGEN

Item	Power W	Volt. V	Lumen
TRH702428	70	24 AC-DC	1900
TRH552228	55	230/12 50-60Hz (with BUILT-IN electronic ballast)	1450
TRH702427	70	24 AC-DC	1900
TRH552227	55	230/12 50-60Hz (with BUILT-IN electronic ballast)	1450
TRH702426	70	24 AC-DC	1900
TRH552226	55	230/12 50-60Hz (with BUILT-IN electronic ballast)	1450
TRH702425	70	24 AC-DC	1900
TRH552225	55	230/12 50-60Hz (with BUILT-IN electronic ballast)	1450

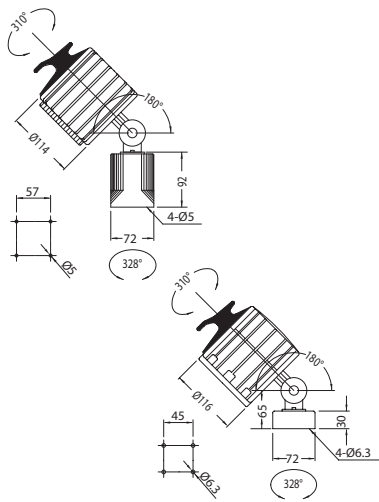

Series TRLH-LED

Item	Power W	Volt. V	Lumen
TRLH122400	12	24 AC-DC	1290

Series TRH-HALOGEN

Item	Power W	Volt. V	Lumen
TRHM702400	70	24 AC-DC	1900
TRHM552200	55	230/12 50-60Hz (transformer included)	1450

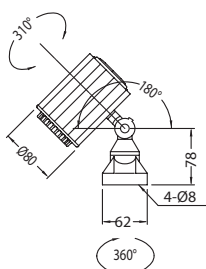

Series TRLB-LED

Item	Power W	Volt. V	Lumen
TRLB052400/S	5	24 AC-DC	520

Series TRHB-ALOGENE

Item	Power W	Volt. V	Lumen
TRHB202400/S	20	24 AC-DC	350



APPLICATIONS

Machines of large dimensions • Large work centres • External cargo handling areas • Industrial buildings • Tunnel constructions
Building sites or industrial installations • Large advertising structures • Architectural lighting

LED LIGHTING MODULES

GIMAX lamps Series FLL-LED are provided of multi-LED modules to optimize the homogeneous light distribution. The colour temperature in use is 4500°K (cool white).

Lifetime comparison among the various light sources

Incandescent lamps500÷2.000 hours

LED lamps.....30.000÷50.000 hours

Advantages of LED lighting

- High efficiency LED diodes 100-120 Lm/W
- Average duration 30.000÷50.000 h
- Instantaneous light emission at switching-on
- Total exploitation of light emission
- Colour rendering index CRI 70-80
- Energy efficiency class A+++
- Working temperature -20°C ÷ +50°C

ELECTRONIC BALLASTS

- Made with selected components of very high quality.
- The operating frequency is well above the threshold of human perception allowing to minimize the stroboscopic effect from light emission providing a pleasant visual well-being.
- To guarantee such a duration, components in use completely correspond to the features that usage requires in



Series LED SLIM - LINEAR LED

terms of duration and working temperature.

- Voltage supply, 110-230V ac, or upon request, 24-48V ac.

LAMP TUBE

- Lamp Tube entirely made in extruded or die-cast aluminium with anti-corrosion treatment extremely resistant to atmospheric agents.
- Shape and tube designed to obtain the maximum heat

dissipation.

- Protective screen in tempered glass or unbreakable polycarbonate with perimetric O-ring suitable to avoid infiltrations.
- Front closure through a flange with metrical screws or lock clips in steel.
- Protection degree IP65-IP66-IP67 (depending on the model) suitable for outdoor use or in extreme humid

areas.

- Adjustable mounting brackets for light beam orientation or eyelets for ceiling suspension.
- Cable gland IP67 provided of electrical cable for power supply connection.

ROUND LED reflectors



Features

- Lamp tube in LED die-cast aluminium IP65 suitable to optimize heat dissipation
- Brackets in steel for wall or ceiling fixation
- External finishing with polyurethane resin suitable for outdoor use
- Rubber O-rings in waterproof silicon
- High transparent polycarbonate screen
- Waterproof cable gland (IP67)
- Light beam angle 120° (or 60° on demand)
- High efficiency drivers 110-230V programmed to optimize lifetime and light efficiency of LED modules
- Power Factor >0,95
- Modules with multi LEDs with colour temperature 4500°K
- Lifetime 50.000 hours
- Colour rendering index RA >80
- Working temperature -20°C ÷ +60°C
- Lenses in polycarbonate to get a light beam angle 60° (on demand)

Item	Power W	Volt. V	Luminous flux Lm.	Dimensions D. x H. mm
FLL10022K0/UF/GX	100	110 - 230 AC	13000	350 x 210
FLL20022K0/UF/GX	200	110 - 230 AC	26000	420 x 220



Accessories



Item **FLL10022K0/UF/GX** (x 100 W)
 Item **FLL20022K0/UF/GX** (x 200 W)
 Accessory lenses in polycarbonate to get a light beam angle 60°

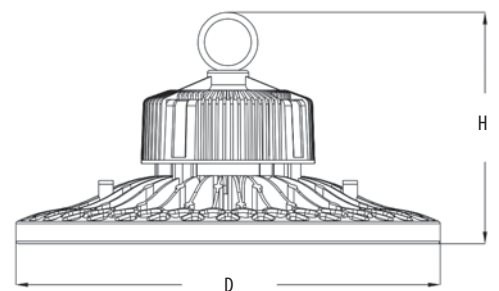

Features

- LED lamp tube in die-cast aluminium IP66
- External finishing with anti-oxidation treatment
- Waterproof rubber O-rings in silicone
- Polycarbonate screen Bayer with symmetrical directional lenses
- Light beam angle 90°
- Waterproof cable gland (IP67)
- High efficiency drivers 110-230V programmed to optimize lifetime and light efficiency of LED modules
- Modules with multi LEDs with colour temperature 4500°K
- Lifetime 50.000 hours
- Power Factor >0,95
- Colour rendering index RA >80
- Working temperature -20°C ÷ +60°C
- Accessories for ceiling, wall mounting or adjustable brackets (on demand)



Item	Power W	Volt. V	Luminous flux Lm.	Dimensions D. x H. mm
FLLP10022K0/ML/GX	100	110 - 230	12000	141 x 600 x 134
FLLP20022K0/ML/GX	200	110 - 230	24000	141 x 1200 x 134

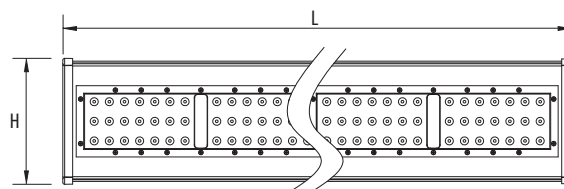
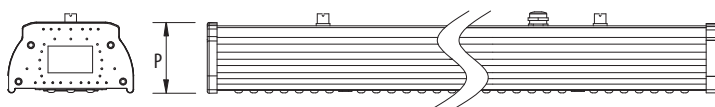

Accessories



Item **FLLP2CAT/ZDL**
Kit of 2 chains with snap hooks for ceiling suspension (Length 500 mm)



Item **FLLPSTAF/ZDL**
Kit of 2 non-adjustable brackets for ceiling or wall mounting



Item **FLLPSTAF/REG/ZDL**
Kit of 2 adjustable brackets for ceiling or wall mounting



Features

- Lamp tube in die-cast aluminium IP65 with slim profile
- External finishing with anti-oxidation treatment
- Waterproof rubber O-rings in silicone
- Tempered glass with steel click closure
- Aluminium reflector
- Light beam angle 120°
- Waterproof cable gland (IP67)
- High efficiency drivers 110-230V programmed to optimize lifetime and light efficiency of LED modules
- Modules with multi LEDs with colour temperature 4500°K
- Lifetime 30.000 hours
- Power Factor >0,95
- Colour rendering index RA >80
- Working temperature -20°C ÷ +60°C

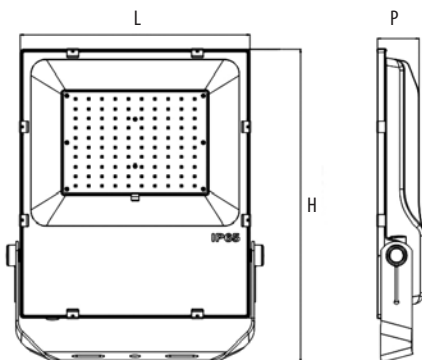

Item	Power W	Volt. V	Luminous flux Lm	Dimensions H x L x W mm
FLL5022K0/US/GX	50	110 - 230 AC	5000	265 x 220 x 47
FLL10022K0/US/GX	100	110 - 230 AC	10000	345 x 295 x 53
FLL20022K0/US/GX	200	110 - 230 AC	22000	400 x 360 x 53



Features

- Lamp tube in die-cast aluminium IP67 with super-slim profile
- Special anti-oxidation surface treatment designed for outdoor use
- Designed for fixation on top of a pole Ø 60mm
- Provided of turnable accessories 180° for fixation on a pole
- Waterproof rubber O-rings in silicone
- Polycarbonate screen Bayer with symmetrical directional lenses
- Aluminium reflector
- Light diffusion: axis X 75°
axis Y 145°
- Cable input from the pole centre
- High efficiency drivers 110-230V programmed to optimize lifetime and light efficiency of LED modules
- Modules with multi LEDs with colour temperature 4500°K
- Lifetime 30.000 hours
- Power Factor >0,95
- Colour rendering index RA >80
- Working temperature -20°C ÷ +60°C

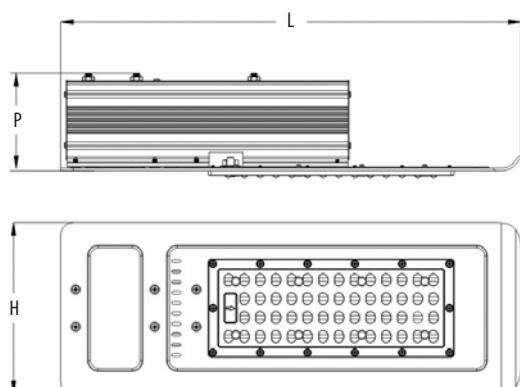

Item	Power W	Volt. V	Luminous flux Lm	Dimensions H x L x W mm
FLL3022K0/P/AS/GX	30	110 - 230 AC	3000	135 x 365 x 85
FLL6022K0/P/AS/GX	60	110 - 230 AC	6000	160 x 432 x 90
FLL12022K0/P/AS/GX	120	110 - 230 AC	12000	215 x 632 x 90

087.0

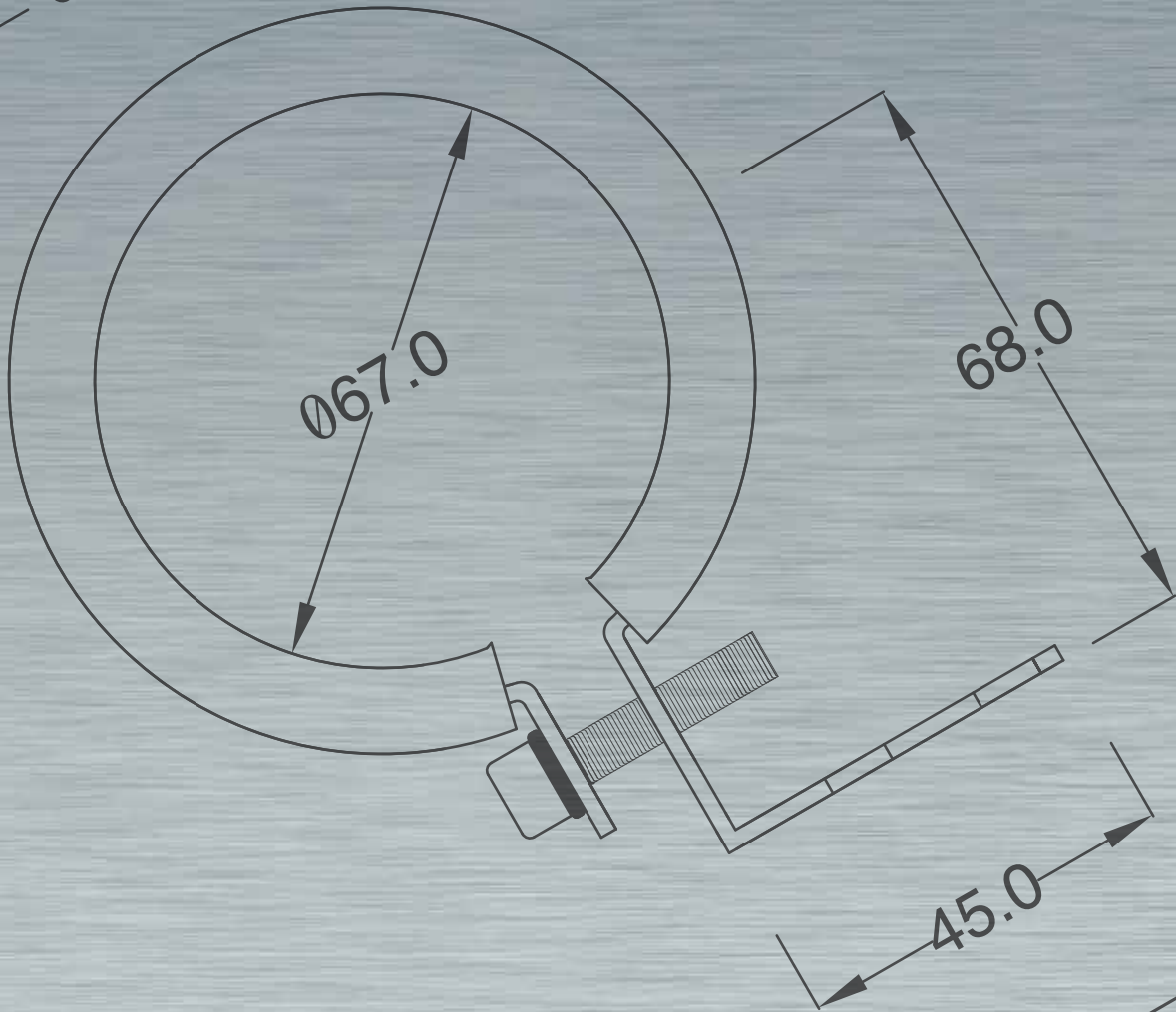

20.0

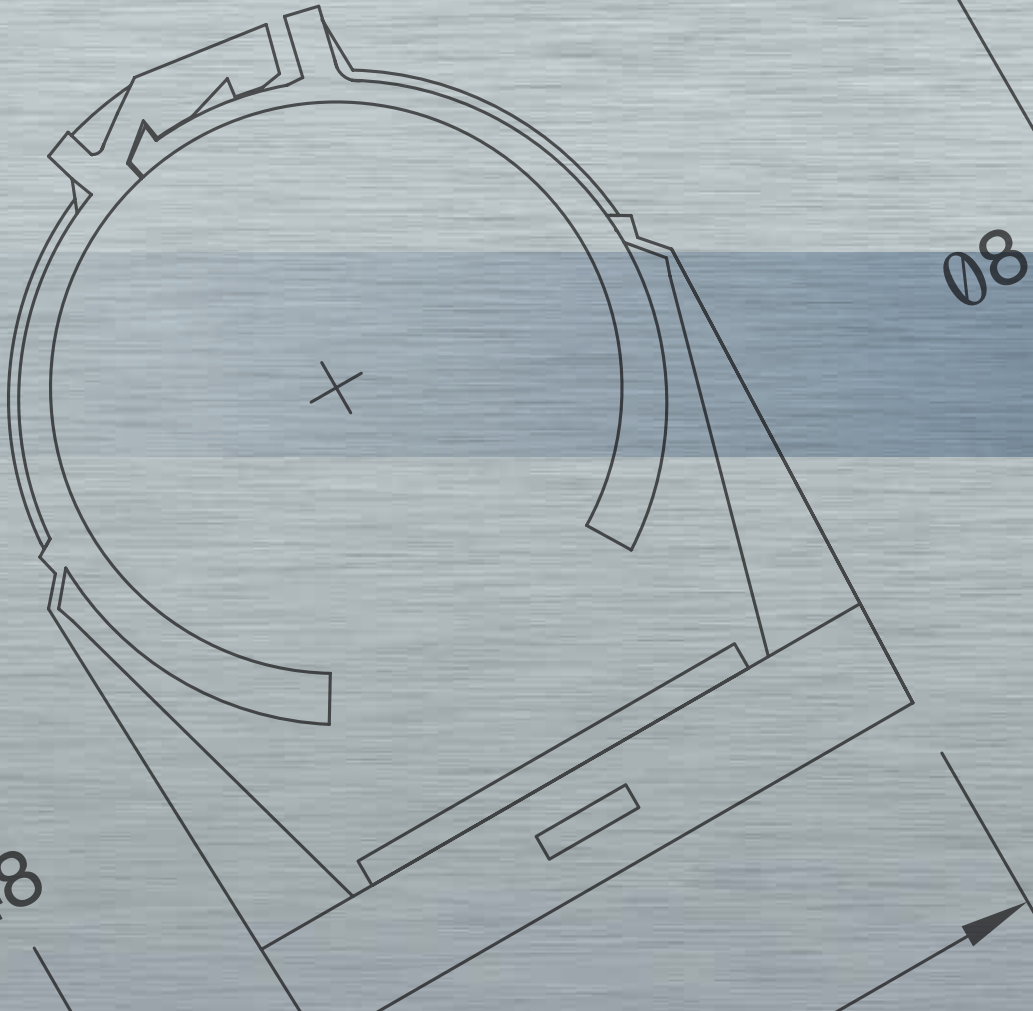

08

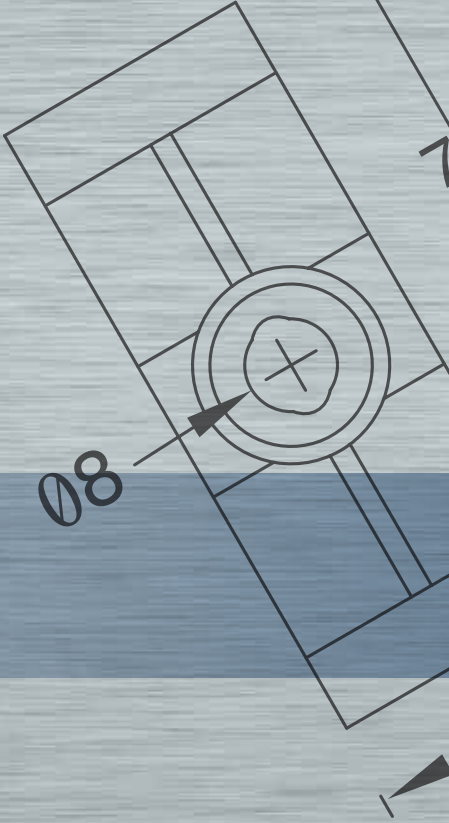

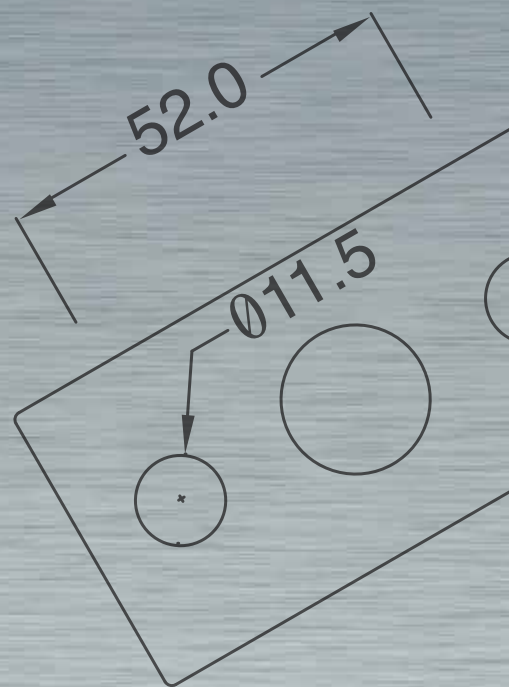
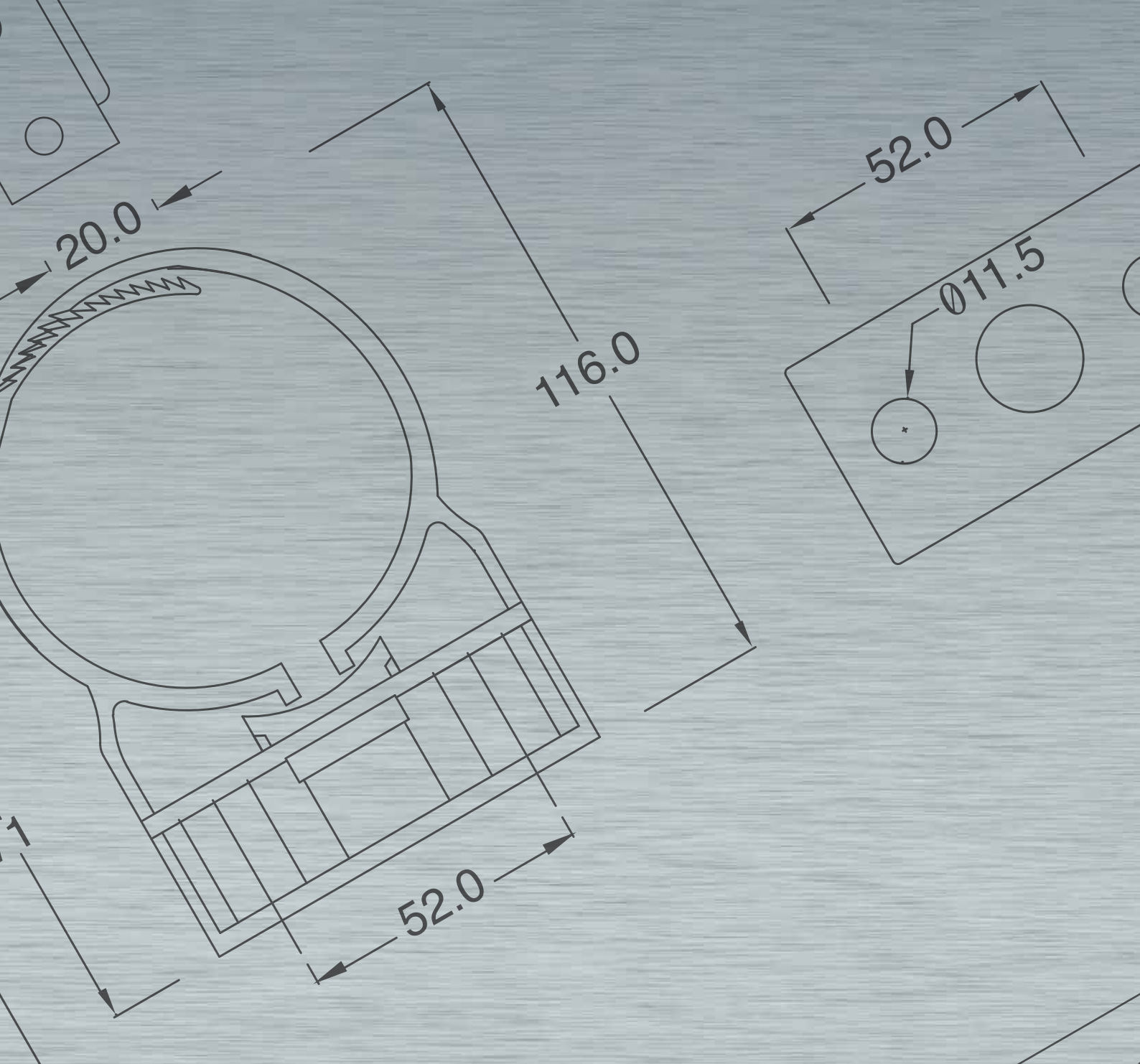

ACCESSORIES and SPARE PARTS

SIRIO Series

MOUNTING BRACKETS for lamps with tube \varnothing 60 and 70 mm

Features

Mounting brackets for lamps \varnothing 60 and 70 mm in **electro-galvanised steel or AISI 304** with fixing screws and rubber strips resistant to oils, acids and industrial solvents. High elasticity suitable to absorb vibrations of machines where the lamp is installed.

For lamps \varnothing 70 mm

Item	Description
STD1	Short angular bracket \varnothing 70 mm in electro-galvanised steel
STD1/INOX	Short angular bracket \varnothing 70 mm in stainless steel AISI 304

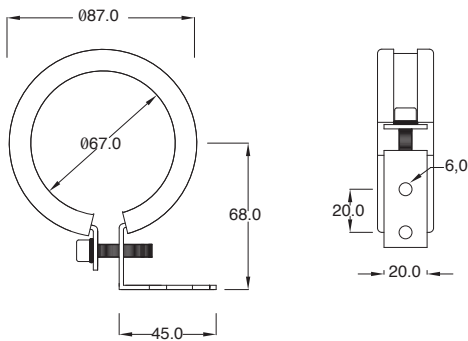

For lamps \varnothing 60 mm

Item	Description
STD1/60	Short angular bracket \varnothing 60 mm in electro-galvanised steel
STD1/60/INOX	Short angular bracket \varnothing 60 mm in stainless steel AISI 304

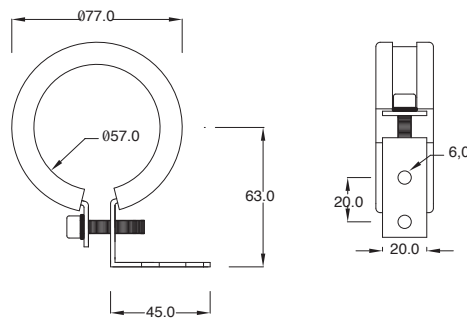

Item	Description
STD2	Long angular bracket \varnothing 70 mm in electro-galvanised steel
STD2/INOX	Long angular bracket \varnothing 70 mm in stainless steel AISI 304

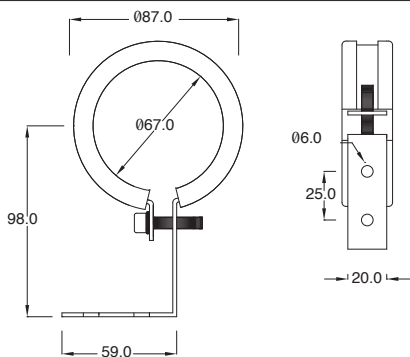

Item	Description
STD2/60	Long angular bracket \varnothing 60 mm in electro-galvanised steel

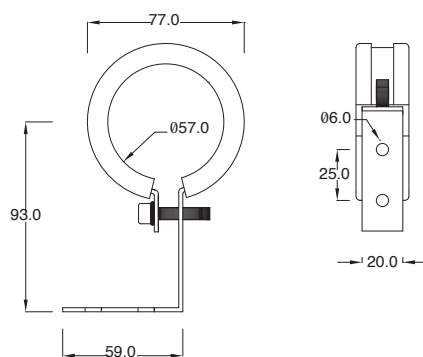

Item	Description
STD3	Straight bracket \varnothing 70 mm in electro-galvanised steel

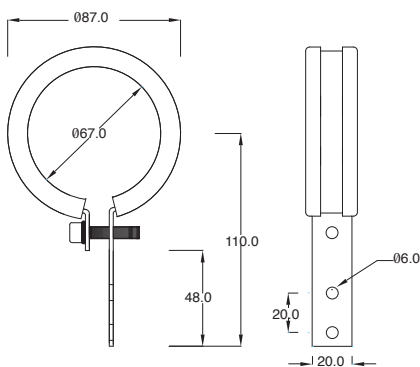

MOUNTING CLIPS for lamps with tube from Ø 40 to 70 mm

Features

Mounting clips for lamps Ø 40/42/50/60 and 70 mm in polypropylene non-producing halogens.

Excellent chemical resistance to inorganic acids and alkaline solutions. Low resistance to acetone, organic acids, gasoline, benzol, diesel and oils.

Working temperature -40°C ÷ +90°C.

Item	Description
CLC70	Clip Ø 68-70 mm

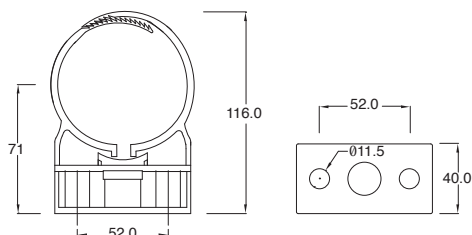

Item	Description
CLC60	Clip Ø 58-60 mm

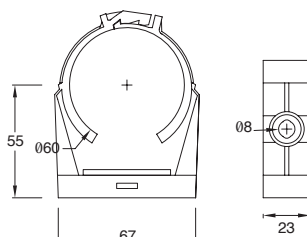

Item	Description
CLC50	Clip Ø 48-50 mm

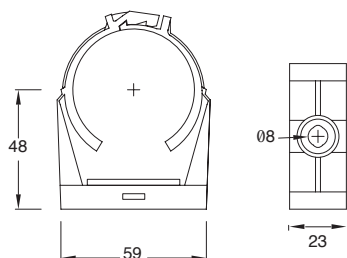

Item	Description
CLC43	Clip Ø 40-43 mm

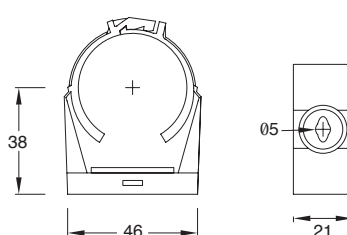

Item	Description
OB0/01	Clip Ø 50 mm

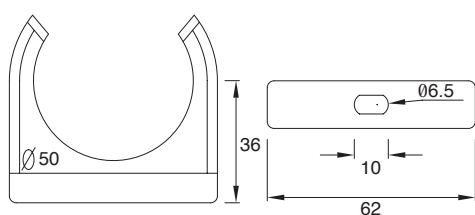

Item	Description
OB0/02	Clip Ø 43-40 mm

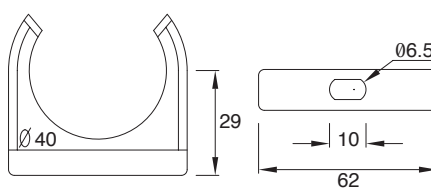

Item	Description
MGP01/OB001	Clip Ø 50 mm with magnet

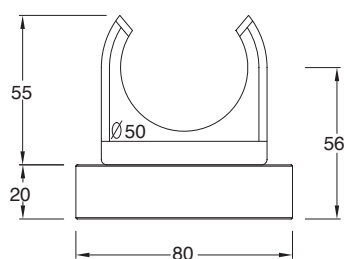

Item	Description
MGP01/OB002	Clip Ø 43-40 mm with magnet

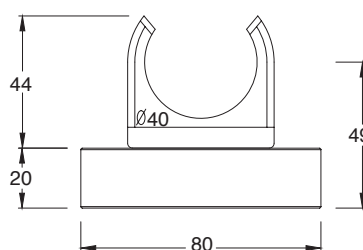

SIRIO Series

ELECTRONIC BALLASTS for lamps with tube Ø 50/60/70 mm

Electronic ballasts (spare part for lamps)

- Electronic high frequency circuit with digital control switching, 24Vac, 24Vdc, 42Vac, 48Vac, 110-120Vac, 230Vac
- Power stage with Power Mosfet. Protected against outgoing short circuits for a no load operation, straightening effect or exhaustion of the Tube
- BUILT-IN fuse for powerline protection
- In compliance with Standards EN 60928 (Safety), EN 61547 (Immunity EMC), EN61000-3-2 (Wave Suppression), EN61000-3-3 (Flickering), EN 55015 (Radio disturbances), EN 60929 (Safety), EN 60921 (Performances) (for the exact codes contact our sales department)



Ballast in metal enclosure, separate from the lamp (model "S1")

Ballast in electro-galvanised metal enclosure, dimensions: 196(L) x 36(H) x 40(W) mm.
Please specify series, voltage supply and lamp item you are interested in.
Protection degree IP2X. (To get right part, please contact our sales department).



Ballast in metal enclosure, separate from the lamp (model "S2")

Ballast in insulated plastic enclosure with 2 cable glands to power circuit and lamp.
Dimensions: 230(L) x 45(H) x 45(W) mm.
Please specify series, voltage supply and lamp item you are interested in.
Protection degree IP44. (To get right part, please contact our sales department).



Ballast in polycarbonate, methacrylate or glass enclosure (model "S3-S4-S5-S6-S7")

Ballast in waterproof tube Ø 50 mm, 60 mm or 70 mm in Polycarbonate, Methacrylate or Borosilicate Glass with 2 cable glands to power circuit and lamp.
Please specify series, voltage supply and lamp item you are interested in as well as mounting bracket type if needed.
Protection degree IP67 (To get the right part, please see page regarding lamp needed).



Ballast in polycarbonate, methacrylate or glass enclosure (model "S4S-S6S-S7S")

Ballast in waterproof tube Ø 50 mm or 60 mm in Polycarbonate, Methacrylate or Borosilicate Glass with 2 cable glands to power circuit and lamp.
Please specify series, voltage supply and lamp item you are interested in.
Provided of four fixing holes.
Protection degree IP67 (To get the right part, please see page of lamp needed and add "S" to item).



ORIENTAL Series

ACCESSORIES AND SPARE PARTS for halogen and LED lamps

Antiglare grid and magnet

Item	Description
ORGRM	Antiglare grid for halogen lamp Series Oriental (TRH) in black satin aluminium
MGP07	Magnet for lamp Series Oriental (TRH, ORL, TRLB) Nr. 4 threaded holes M5, drilling distance 45x45mm



Mounting brackets

Item	Description
ORMV01	Screw clamps for fixing lamp Series Oriental in black painted steel. Nr. 4 threaded holes M4, drilling distance 45x45mm
ORST01	Angular brackets for fixing lamp Series Oriental in black painted steel. Nr. 4 threaded holes M4, drilling distance 45x45mm



Electronic ballasts

Item	Description
TRE7/22/12	Separate electronic ballast 230/12V to power lamp Series Oriental
TRE7/22/12/TRV	Electronic ballast 230/12V as spare part of halogen lamp Series Oriental (assembled inside the square sectioned arm)



Spare halogen lamps

Item	Description
HALO70/24	Halogen lamp 24V 70W, connection PK225, high light efficiency and long lifetime (1000 hours)
HALO55/12	Halogen lamp 12V 55W, connection PK225, high light efficiency and long lifetime (1000 hours)



USEFUL INFORMATION

Standards CEI EN 60529 1997-06 (IEC529 ex CEI 70-1) + A1 2000-06 "Protection degree of enclosures" refers to a classifying system regarding protection degree of enclosures in use for electrical equipment. This allows to indicate, through the IP code, the level of protection against penetration of external solid bodies and water. IP code has to be guaranteed in the "ordinary service conditions of the equipment".

Feature letters

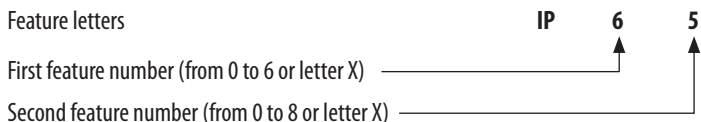

The first number indicates protection degree against penetration of external solid bodies

SYMBOL	IP	SIGNIFICANCE
	0	No protection
	1	Protected against solid bodies higher than Ø 50mm
	2	Protected against solid bodies higher than Ø 12mm
	3	Protected against solid bodies higher than Ø 2,5mm
	4	Protected against solid bodies higher than Ø 1mm
	5	Protected against dust (no hazardous deposit)
	6	Completely protected against dust

The second number indicates protection degree against penetration of liquids

SYMBOL	IP	SIGNIFICANCE
	0	No protection
	1	Protected against vertically dripping water
	2	Protected against vertically dripping water or rain up to 15° from the vertical
	3	Protected against spraying water or rain up to 60° from the vertical
	4	Protected against splashing of water from all directions
	5	Protected against water jets
	6	Protected against powerful water jets
	7	Protected against temporary immersion effect
	8	Protected against continuous immersion effect

Class of insulation

SYMBOL	CLASS	DESCRIPTION OF PROTECTION DEGREE
	I	Component with main insulation provided of device for mass connection to a protection conductor.
	II	Component with double or reinforced insulation with no device for connection to a protection conductor.
	III	Component with reduced insulation as exclusively powered by a very low voltage safety system (SELV) in which voltage values are never higher than those generated by that system.

“ We hope that you have found the best solution for your needs amongst our various proposals in this catalogue.

We are proud to underline that our main force, that has made our Company grow these years, is the design and realisation within our company of all our products, starting from the necessities of our clients.

In case you have not found a product that suits your needs, our offices are at your disposal to assist you in finding the best possible solution.

Contact our commercial and technical department at the following number: 0039 (0)584 81743 and test our competence and professionalism. ”

Thank you and...

...See you soon

 The Gimax Team



Via dell'Arabescato, snc
Zona Industriale Portone - 55045 Pietrasanta (LU) - Italy
Tel. +39 (0) 584 81742/3 - Fax +39 (0) 584 81744
www.gimaxsrl.it - info@gimaxsrl.it